

**REVISED PLAN**  
SHOWING AREA UNDER PRIVATE FOREST SITUATED  
AT RAIYA VILLAGE OF SALCETE TALUKA

SCALE : 1:2000

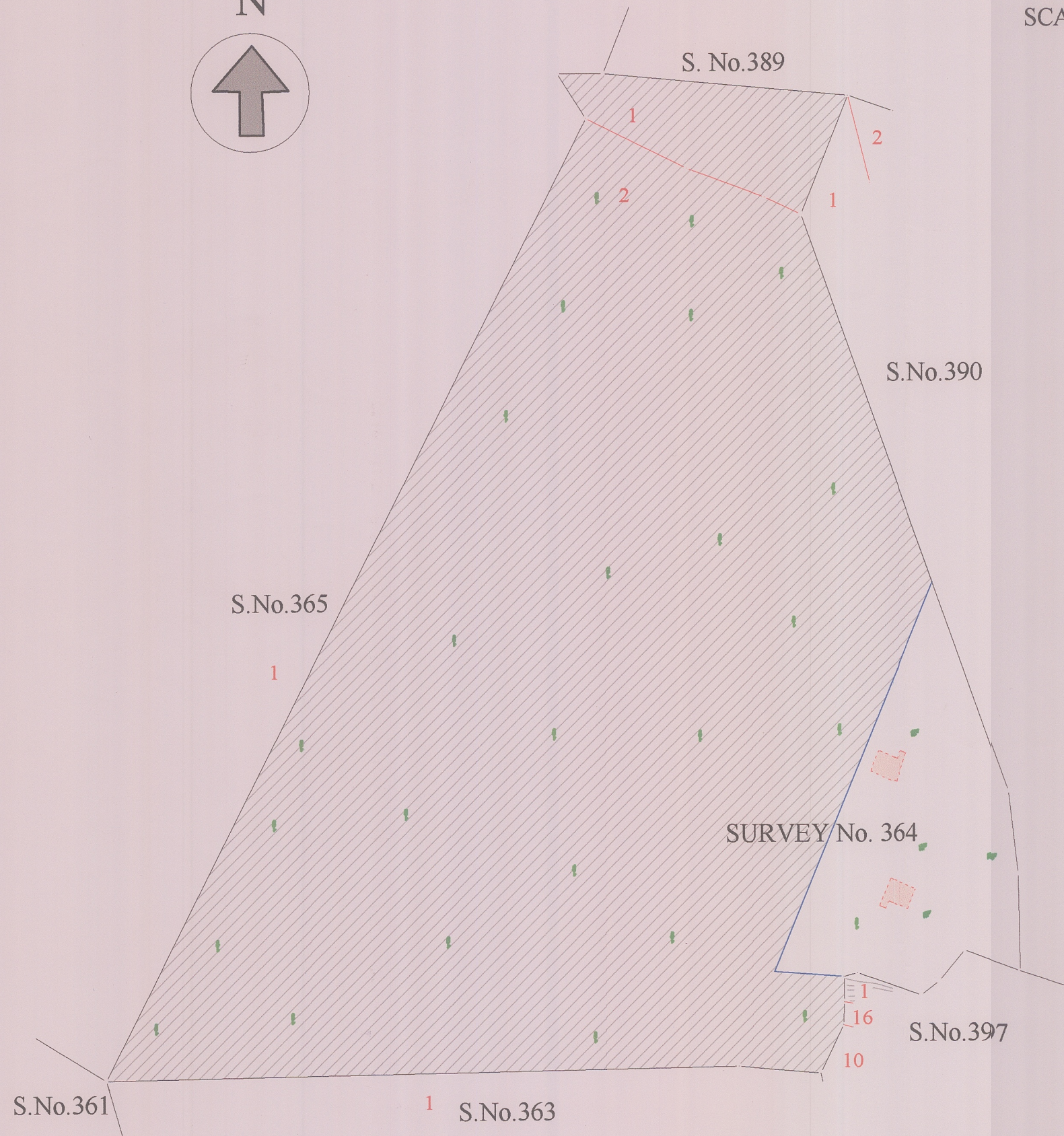
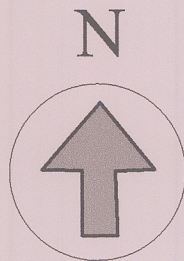

*[Signature]*  
Dy. Conservator of Forests  
South Goa Division  
Margao - Goa.

<i>[Signature]</i> Director DSLRL or Nominee	<i>[Signature]</i> Addl. Collector Rev. - North Goa
<i>[Signature]</i> Addl. Collector Rev. - South Goa	<i>[Signature]</i> A.C.F. North Goa Div.
<i>[Signature]</i> A.C.F. South Goa Div.	<i>[Signature]</i> Sandeep Azrenkar Environmentalist
<i>[Signature]</i> Sd. Dy. Conservator of Forests South Goa Division	<i>[Signature]</i> C.F.S./M.S. Working Plan Div.
<i>[Signature]</i> Chairman South Goa Division	

PLAN IS PREPARED AS PER THE DIRECTION CONCERNED  
RANGE FOREST OFFICE, AQUEM (SOUTH-GO), MARGAO

- 1) SHRI. SAMIR X. RAJGURU  
FIELD SURVEYOR, DSLR, PANAJI-GOA *[Signature]* 29-5-19
  - 2) SHRI. SANDIP S. MADELKAR  
FIELD SURVEYOR, DSLR, PANAJI-GOA *[Signature]* 28-05-19.
- Points shown on ground by:-  
Shri. Sandip S. Madelkar, Forest Guard Range Office, Aquem, South Goa, Margao. *[Signature]* 29/05/19

LEGEND	
	AREA UNDER PRIVATE FOREST
	EXISTING DEMARCATED PRIVATE FOREST AREA
	VILLAGE BOUNDARY
	SURVEY BOUNDARY
	SUB-DIVISION BOUNDARY

**AREA STATEMENT**

SURVEY Nos.	EXISTING DEMARCATED AREA	ADDITIONAL SURVEYED AREA	TOTAL AREA IN HECTARES
364/1		0.345	0.345
364/2 (part)		7.306	7.306
<b>GRAND TOTAL =</b>			<b>7.651</b>