



FINAL REPORT
OF
STATE LEVEL EXPERT
COMMITTEE
(SH.V.T. THOMAS :CHAIRMAN)
FOR
PRIVATE FORESTS
OF
NORTH GOA
GOVERNMENT OF GOA

ACKNOWLEDGEMENT

I have great pleasure in submitting this report of the Committee constituted by the Government of Goa to identify Private Forest areas in different Talukas of North Goa Division.

I express my sincere thanks to the Government of Goa for permitting me to head the Committee to carry out our job independently and without any interference.

The Committee could carry out this task with the active participation of the members with timely advice and guidance and frequent field visit. I am particularly thankful to Shri Richard D'Souza, Shri Ajay Saxena, PCCF, members Dr. G.T. Kumar, Shri Milind Karkhanis, Shri Kuldeep Sharma DCF(N), Shri Rajendra Kerkar, Dr. Nitin Sawant and Shri Paresih Rivankar, Shri Pradeep Verekar and Shri Anant Samant, Member Secretaries. I acknowledge the services rendered by Shri Kiran Gawde and Shri Pramod Naik, Field Surveyors of DSLR. I am thankful to Shri S.R. Prabhu, SDEO (Mapusa) and Shri Shamsundar Gawas- RFO and other territorial RFO's and field staff for their co-ordination and involvement. I also express my sincere thanks to the Sarpanchas and Panch members of various village Panchayats for their support to carry out the work.

Place: Ponda
October, 2018.
Asvina, Saka 1940.



(V.T. Thomas)

Chairman
State Level Expert Committee
For
Identification of Private Forest
In North Goa

FINAL REPORT OF THE STATE LEVEL EXPERT COMMITTEE,
NORTH GOA DISTRICT.

Constitution of the committee -

In pursuance of the directive contained in the order dated 16 December 2009, of Hon'ble High Court of Bombay at Goa, the Government of Goa is pleased to constitute following Committees vide notification No 7-1-2009/FOR/439 dtd.27/12/2012 for the purpose of identification of balance areas of Private Forests in the State of Goa.

North Goa Forest Division Committee

1. Shri. V.T. Thomas (Ex-Forest Officer)..... Chairman
Porvorim, Bardez - Goa.
2. Dy. Conservator of Forests, Member
North Goa Division, Ponda - Goa
3. Dr. Nitin Sawant, Porvorim , Bardez Goa Member
4. Shri Rajendra Kerkar, Keri, Sanquelim – Goa Member
5. An Officer of the Revenue Department, Member
Not below the rank of Dy. Collector.
6. An officer of the DSLR, Member
Not below the rank of Head Surveyor.
7. Sub Divisional Forest Officer, Member Secretary
Ponda - Goa

The terms of reference and other conditions of the Committee:-

1. The Committee was to identify the balance areas of private forests in North Goa Division that have not been covered by the Sawant Committee Report and the Karapurkar Committee Report.
2. The Committee was to locate the private forests on ground individually, and judge them ocularly in conformation with crop composition (75% or more of the trees to be of forest nature) and canopy density (0.4 or more).
3. The DSLR/Revenue officer was to immediately estimate, through the land Surveyors, the geographical areas of such forests.
4. If such forests are found to be satisfying the three criteria (i.e. geographical area 5 Ha Or more if not contiguous to Government forests, crop composition of 75% or more trees of forest species and canopy density 0.4 or more) by the Committees, the DSLR and Revenue officers were to get

such identified private forests surveyed, plotted them on the map and incorporated them in the plans of the respective Survey Numbers.

For enabling this, the respective District Collectors, in coordination with the Director of Settlement and Land Records, was to depute a team of necessary and sufficient number of field surveyors to be at the disposal of the DSLR's officers in the Committees

5. The Committees was to demarcate such identified private forests from the non-forest area on the ground by pegs and on the maps as well
6. The Committees was to submit their monthly progress report to the Principal Chief Conservator of Forests, in the prescribed Format.

As soon as private forests is finally identified (demarcated with pegs) in a particular survey number, the same were to be intimated by the Committees to DCF (Working plan) and upon receiving such intimation, the DCF (WP) was to immediately take steps to fix boundary stones around such private forests.

ACTION TAKEN BY THE COMMITTEE

1. Prospective areas were located by using Regional Plan 2021 with respect to already identified and demarcated private forests, natural cover and Govt. forests. Village maps along with google maps and were also used for locating potential private forests. Extensive field inspections were carried out to verify the field condition in respect of composition of existing tree cover, density and areas likely to exceed 5 ha. Such areas were brought under provisional list of private forest
2. The Committee met on 134 occasions/days for field meetings/field inspections. The list of provisionally identified forest is enclosed as **Exhibit-I**.
3. Actual survey and demarcation by wooden pegs were taken up in the provisionally identified areas by a team of Surveyors from the Directorate of Settlement and Land Records since 2015.
4. Out of 1661.72 ha. (Approximately) of provisionally identified forests, an area of 326.51 ha was surveyed and demarcated. A list of which is enclosed as **Exhibit – II**. Before the final survey and demarcation, the concerned land owners were intimated and their objections/representations were evaluated with site inspections and genuine cases were considered for deletion and necessary changes were made in the final survey plan. List of such areas which were deleted is mentioned in **Exhibit – I**
5. These finalised survey plans were submitted to the DCF, North for taking up final demarcation in the field with permanent boundary marks. The final survey maps submitted for final demarcation is enclosed as **Exhibit – III**.
6. The committee also attended to many representations made by various NGOs and willing land owners for inclusion into private forest list. Such areas which were fulfilling the criteria of private forest, were also inspected and deserving cases were included to the provisionally identified list. A list of

such areas included into list of Private Forest is also mentioned in Exhibit - I.

RECOMMENDATION OF THE COMMITTEE

1. The committee has provisionally identified an area of 1661.72 ha (approximately) area and out of which an area of 326.51 ha only could be surveyed during the tenure of this committee. Therefore, the exercise of survey should be continued and should be completed at the earliest.
2. On completion of the survey or during it, the actual demarcation of private forest area should be done with boundary stone.
3. Because of their unique ecological, bio-diverse endowments, endemism and aesthetic values, protection of these identified and demarcated private forest areas is of paramount importance. Therefore, adequate protection measures should be put in place by deputing sufficient protection staff.
4. Though the committee has taken utmost care in identifying the provisional private forest areas, there remains a remote chance of locating few more areas which may have inadvertently missed out by the committee.
5. The land owners should be compensated in lieu of income loss due to preservations of trees in their private land on perpetual basis. Adequate incentives to the land owners of these private forest in form of acknowledgements, rewards and long time economic benefits, as the government may deem fit, should invariably be provided for the ecological services rendered by keeping the Forest growth intact for all these years.

Dr. Nalin Sawant
Member

Shri Rajendra Kerkar
Member

Paresh Rivonkar,
Head Surveyor,
Member

Dy. Conservator of Forests,
North Goa Division, Ponda
Member

Sub Divisional Forest Officer
Ponda Goa
Member Secretary

Shri V T Thomas
Chairman

EXHIBIT I

List of provisionally identified Private Forests by V T Thomas SLEC, North Goa Division.

Sr. No.	Name of the Taluka	Name of the Village	Provisionally identified Sy. Nos	Approximate Area	Excluded Sy. Nos.	Additional inclusion	Remarks
1	TISWADI	Murda	26, 34, 39, 40, 41, 42, 43, 44	> 5.0Ha	26, 34, 40, 41, 39, 42, 43, 44	NIL	Surveyed / not fitting into Private Forest criteria
		Cujira	38, 39, 40, 41, 42 & 44	> 5.0Ha	38, 39, 40, 41, 42 & 44	NIL	Surveyed / not fitting into Private Forest criteria
		Gencim	6, 7, 8, 13, 14, 15, 16, 17, 22, 33, 36, 37, 38	> 5.0Ha	7, 8, 13, 14, 15, 16, 17, 22, 33, 36, 37, 38	NIL	Except Sy. No. 8(P), others are not fitting into criteria
		Talaulim	106 & 107	> 5.0Ha		NIL	Except Sy. No. 34(P), others are not fitting into criteria
		Gauli Maule	4, 31, 32, 34, 35, 36, 38, 39	> 5.0Ha	4, 31, 32, 35, 36, 38, 39	NIL	
		Azzocim	5, 6, 8, 61 & 63	> 5.0Ha	5, 6, 8, 61 & 63	NIL	Surveyed / not fitting into Private Forest criteria
		Mancour	57, 59 & 60	> 5.0Ha	57, 59 & 60	NIL	Surveyed / not fitting into Private Forest criteria
		Chorac	461	> 5.0Ha	461	NIL	Surveyed / not fitting into Private Forest criteria
		Carambolim	263, 280, 281, 282, 283, 284, 285, 286, 287, 288, 290, 292, 294	> 5.0Ha	263, 280, 281, 282, 283, 284, 285, 286, 287, 288, 289, 294	NIL	Surveyed / not fitting into Private Forest criteria
		Curca	488 & 49	> 5.0Ha	488 & 49	NIL	Surveyed / not fitting into Private Forest criteria
2	Bardez	Salvador do Mundo	64(P), 65 (P), 66(P), 69(P), 73(P), 78(P), 85(P), 86(P), 116(P), 118(P), 119(P), 135(P), 137(P), 150(P), 151(P), 152(P), 153(P), 154(F), 155(P), 156(P), 158(P), 159(P), 160(P), 162(P), 163(P), 164(P), 227(P), 236(P), 266(P), 267(F), 239(P), 241(P), 251(P), 252(P), 265(P), 266(P), 237(P), 268(P), 269(P), 270(P), 271(P), 272(P), 273(P), 281(P), 282(P), 291(P), 292(P), 295(P), 296(P), 297(P), 298(F), 299(P), 300(P), 301(P), 302(P), 305(P), 306(P), 307(F), 311(P), 312(P), 313(P), 315(P), 321(P), 322(P), 323(P), 324(P), 325(P), 326(F), 327(P), 331(P), 333(P), 337(P), 338(P), 339(P), 341(P), 343(P), 344(P), 345(P), 346(P), 347(F), 348(F), 349(P), 350(P), 351(P), 352(F), 353(P), 355(F), 356(P), 357(F), 358(F), 359(P), 365(P)	200 Ha	64(P), 65 (P), 69(P), 73(P), 78(P), 85(P), 86(P), 78(P), 85(P), 86(P), 116(P), 118(P), 119(P), 137(P), 156(P), 159(P), 159(P), 160(P), 162(P), 163(P), 164(P), 227(P), 236(P), 241(P), 251(P), 252(P), 265(P), 266(P), 270(P), 271(P), 282(P), 291(P), 292(P), 295(P), 297(P), 305(P), 312(P), 315(P), 321(P), 321(P), 325(P), 326(F), 327(P), 331(P), 333(P), 333(P), 341(P), 343(P), 344(P), 345(P), 345(P), 349(P), 350(P), 358(F), 359(P), 365(P)	107 (P), 108(P), 131, 133, 247, 262, 340, 354	

Handwritten notes and signatures at the bottom right of the page, including a signature that appears to be "C. S. Costa" and some illegible text.



Sr. No.	Name of the Taluka	Name of the Village	Provisionally identified Sy. Nos	Approximate Area	Excluded Sy Nos.	Additional inclusion	Remarks
		Socorro	2, 3, 4, 176, 200, 200, 201, 202, 203, 204, 208, 209, 210, 211, 213, 220, 221, 223, 225, 249, 254, 255, 260, 261, 263, 264, 265, 266, 267, 268, 269, 270, 271, 272, 273, 274, 275, 276, 277, 278, 279, 280, 281, 282, 283, 284, 285, 286, 287, 288, 290, 291, 289, 292, 293, 294, 295, 296, 297, 298, 299, 302, 341, 342, 343, 344, 345, 346, 347, 348, 351, 352, 354, 356, 357, 358, 359, 361, 362, 402, 403, 346, 345, 407/7, 407/8, 407/9.	100Ha	2, 3, 4, 176, 204/1, 208, 221, 223, 265.	341, 342, 343, 344	Yet to Survey
		Penna de Franca	11, 13, 14, 16, 29, 33, 34, 35, 38, 39, 40, 45, 46, 50, 52, 75, 76, 103, 104, 108, 109, 110, 114, 115, 116, 117, 118, 119, 133, 134, 135, 139, 140, 146, 147, 149, 150, 151, 181, 182, 184, 186, 187, 188, 189, 190, 191 & 192.	100Ha	119/1, 133/1 18/1/3 181/1, 181/2, 184/4	Yet to Survey	Yet to Survey
		Pomburba	9, 11, 13, 16, 29, 50, 54, 72, 73, 83 & 87.	20Ha.	Yet to Survey	Yet to Survey	Yet to Survey
		Siclim	150, 189, 191, 192, 198, 199, 200, 205, 206, 207, 210, 222, 223, 224, 225, 226, 227, 228, 229, 230, 245, 248, 256, 261, 262, 264, 267, 270, 271, 295, 296, 297, 298, 299, 306, 307, 308 & 309.	50Ha.	306/7 & 309/2	Yet to Survey	Yet to Survey
		Claviem	5, 17, 20, 21, 26, 33, 34, 41, 42, 43, 47, 48, 50, 52 & 125	10 Ha	Yet to Survey	Yet to Survey	Yet to Survey
		Pierre	17, 78, 83 & 84.	5 Ha	Yet to Survey	Yet to Survey	Yet to Survey
		Res Magos	41 & 42	5 Ha	Yet to Survey	Yet to Survey	Yet to Survey
		Ucassaim	48, 79, 80 & 87	5 Ha	Yet to Survey	Yet to Survey	Yet to Survey
		Inachindia	71 & 75	5 Ha	Yet to Survey	Yet to Survey	Yet to Survey
		Marna	75, 81, 82 & 86	5 Ha	Yet to Survey	Yet to Survey	Yet to Survey
		Calangute	26, 27, 28, 29, 30, 31, 32, 33, 42, 43, 44, 45, 46, 47, 88, 250, 251, 252, 254, 255, 256, 257, 258, 259, 260, 261, 262, 263, 264, 267, 268, 269, 270.	10 Ha	32/7 & 88/3	Yet to Survey	Yet to Survey
		Camorlim	06, 07, 08, 152, 156, 158, 159, 160, 163, 164, 165, 166, 167, 168, 169, 170, 171, 172.	10 Ha	7/4, 172/1(P)	Yet to Survey	Yet to Survey
		Oxel	31, 37, 46, 76, 77, 78, 79, 80	5 Ha	Yet to Survey	Yet to Survey	Yet to Survey
		Sangolda	94, 21, 22, 25, 94	5 Ha	Yet to Survey	Yet to Survey	Yet to Survey
		Assagao	59, 61, 62, 63, 67, 68, 69, 74, 76, 101, 108, 128, 129, 130, 132, 133	10 Ha	128/14	Yet to Survey	Yet to Survey
		Parra	25, 29, 34, 35, 36, 214, 213, 212	5 Ha	Yet to Survey	Yet to Survey	Yet to Survey

UPR
[Handwritten signature]
 C. S. D. D. Santos
[Handwritten signature]

Sr. No.	Name of the Taluka	Name of the Village	Provisionally identified Sy. Nos	Approximate Area	Excluded Sy. Nos.	Additional inclusion	Remarks
3	Pernem	Arpora	48, 49, 50, 51, 52, 53, 57, 58, 59, 61, 65, 67, 69, 93, 94	10 Ha	Yet to Survey	Yet to Survey	Yet to Survey
		Veria	95(P) & 110	5 Ha	95/6-D	Yet to Survey	Yet to Survey
		Terekhol	14 & 15	>5Ha			
		Arambol	185 & 186	5Ha.			
		Pallem	154 & 155	5Ha.			
		Pernem	222 & 224	5Ha.	222		
		Dhargal	361 & 362	5Ha.		Yet to Survey	Yet to Survey
		Cassavomem	7, 10, 268, 269, 270	5Ha.	7, 10, 268, 269, 270		Surveyed / not fitting into Private Forest criteria
		Setora	105, 109, 127, 156, 157, 177, 193, 194, 217, 218, 219, 220, 221, 222, 223, 224, 226, 227, 228, 235	50 Ha	220/0, 221/0, 222/0 & 223/4	--	Sy No 127 subject to it is not a Government Forest
		Kunçaim	48/10	10Ha	Yet to Survey	Yet to Survey	Yet to Survey
4	Ponda	Pind	48/2 (P), 49/2(P) & 50/1 (P), 58(P), 69, 70, 85(P), 86(P), 88, 115, 117, 118, 134, 135, 136, 137, 138, 142, 197, 199, 200, 201, 205, 209.	100Ha	199 (P)	Yet to Survey	Yet to Survey
		Cunçolem	22, 23, 24, 25, 27, 31 (P), 32 (P), 34, 35, 36, 37, 65, 69, 70, 71, 72, 99, 100.	75Ha	Yet to Survey	Yet to Survey	Yet to Survey
		Accoia	56	5Ha	Yet to Survey	Yet to Survey	Yet to Survey
		Vegurme	10, 62, 64, 65	5Ha	Yet to Survey	Yet to Survey	Yet to Survey
		Nranca	10, 11, 12, 15, 17, 19, 21, 101, 102, 123, 129, 186, 227,	10Ha	Yet to Survey	Yet to Survey	Yet to Survey
		Borim	84, 85, 86, 87, 111, 113, 115, 117, 118, 119, 122, 123, 127, 128, 129, 130, 131, 132, 133, 134, 135, 136, 137, 141, 155, 249, 250, 259, 260	50Ha	Yet to Survey	Yet to Survey	Yet to Survey
		Cueula	1, 4, 10, 11, 28, 33, 35, 37, 46, 48, 53, 51	10Ha	Yet to Survey	Yet to Survey	Yet to Survey
		Kocar	63	5Ha	Yet to Survey	Yet to Survey	Yet to Survey
		Panchwadi	104, 125, 128, 141	5Ha	Yet to Survey	Yet to Survey	Yet to Survey
		Bandora	216 & 221.	5Ha	Yet to Survey	Yet to Survey	Yet to Survey
4	Dharbandora	Ponda	83 & 84	5Ha	Yet to Survey	Yet to Survey	Yet to Survey
		Curti	49, 57, 58, 59, 63, 99, 100	5Ha	Yet to Survey	Yet to Survey	Yet to Survey
		Piliern	7, 11, 15 & 16	5Ha	Yet to Survey	Yet to Survey	Yet to Survey
		Sangod	10, 91, 21/2, 25/1-A, 25/2	10Ha	Yet to Survey	Yet to Survey	Yet to Survey

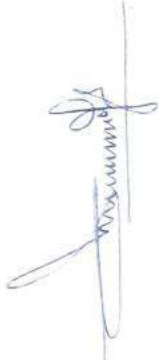
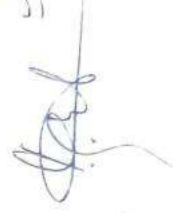

Sr. No.	Name of the Taluka	Name of the Village	Provisionally identified Sy. Nos	Approximate Area	Excluded Sy. Nos.	Additional inclusion	Remarks
5	Sattari	Dharbandora	71, 72, 94, 99, 100, 101, 104, 105, 106, 108, 178, 179	10Ha	Yet to Survey	Yet to Survey	Yet to Survey
		Sacorda	14	5Ha	Yet to Survey	Yet to Survey	Yet to Survey
		Shigao	21	5Ha	Yet to Survey	Yet to Survey	Yet to Survey
		Mollem	40/1	5Ha	Yet to Survey	Yet to Survey	Yet to Survey
		Keri	21, 22, 24, 25, 29, 93, 100, 101, 102, 125,	500Ha	Yet to Survey	Yet to Survey	Yet to Survey
		Poocem	54, 55 & 57.	5Ha	Yet to Survey	Yet to Survey	Yet to Survey
		Ponocem	5, 6, 7, 37 (P),	5Ha	Yet to Survey	Yet to Survey	Yet to Survey
		Vantem	6, 7, 8, 9, 27, 28, 29,	5Ha	Yet to Survey	Yet to Survey	Yet to Survey
		Nayem	10/1 & 10/2.	5Ha	Yet to Survey	Yet to Survey	Yet to Survey
		Rivem	10, 11 & 23 (P)	5Ha	Yet to Survey	Yet to Survey	Yet to Survey
6	Bicholim	Conquirem	29	5Ha	Yet to Survey	Yet to Survey	Yet to Survey
		Xelpe-Curao	23	5Ha	Yet to Survey	Yet to Survey	Yet to Survey
		Lalambarcem	105 & 106.	5Ha	Yet to Survey	Yet to Survey	Yet to Survey
		TOTAL		1661.72			

 Sub. for Survey (Contd)

EXHIBIT - II

**List of Finally Identified Private Forests After Field Survey by
V T Thomas, SLEC, North Goa Division.**

Sr. No.	Name of the Taluka	Name of the Village	Finally Identified Sy. Nos. after field survey	Area	Remarks
1	Tiswadi	Murda	--	NIL	Surveyed/not fitting into Pvt Forest criteria
		Cujira	--	NIL	
		Gancim	6/1(P)	23.99 Ha	Surveyed & plan submitted to DCF, North Goa
		Talaulim	106/1 (P) 107/1 (P)	99.59 Ha	
		GauliMaula	34/1-B (P)	9.93 Ha	
		Azzocim	--	NIL	Surveyed/not fitting into Pvt Forest criteria
		Mandur	--	NIL	
		Chorao	--	NIL	
		Carambolim	--	NIL	
		Curca	--	NIL	
			SUB. TOTAL	133.51 ha	

[Handwritten signatures and initials]

Sr. No.	Name of the Taluka	Name of the Village	Finally Identified Sy. Nos. after field survey	Area	Remarks
2	Bardez	Salvador do Mundo	66/1(P), 66/2, 66/2-A, 66/3, 66/4(P), 66/5(P), 66/6, 66/7, 66/8, 66/9, 66/12(P), 66/14, 107/1(P), 107/2(P), 107/3(P), 107/4 (P), 107/5(P), 107/6(P), 107/7, 107/8, 107/9, 108/1(P), 108/1-A (P), 131/1 (P), 131/2(P), 131/3 (P), 131/4 (P), 131/6 (P), 131/7 (P), 131/8(P), 131/10, 131/11, 131/12, 131/13, 131/14, 131/15, 131/16, 133/1(P), 135/1, 135/2, 135/3, 135/4, 135/5, 135/6, 135/7, 135/8, 135/9, 135/10, 135/11, 135/12, 135/13, 135/14, 135/15, 135/16, 135/17, 150/1(P), 150/2 (P), 150/3 (P), 150/4(P), 150/5(P), 150/7 (P), 150/8 (P), 150/9 (P), 150/10 (P), 150/11, 150/12, 150/13, 151/3 (P), 151/4 (P), 151/5 (P), 151/6 (P), 151/7 (P), 151/8 (P), 151/9 (P), 151/10, 151/11, 151/12 (P), 151/13 (P), 151/14 (P), 151/15 (P), 151/16 (P), 151/17 (P), 151/18, 151/19, 151/20, 151/21, 151/22, 151/23, 151/24, 152/1 (P), 152/2, 152/3 (P), 152/4 (P), 152/5, 152/6 (P), 152/7 (P), 152/8, 152/9 (P), 152/10, 152/11 (P), 152/12 (P), 152/13 (P), 152/14 (P), 152/15 (P), 152/16(P), 152/17 (P), 153/1, 153/2, 153/3 (P), 154/1 (P), 154/2 (P), 154/3 (P), 154/4, 154/5 (P), 154/6 (P), 154/7, 154/8, 154/9, 154/10, 154/11, 154/12, 154/13 (P), 155/2, 155/3 (P), 155/5 (P), 155/6 (P), 155/7, 155/8, 158/1 (P), 158/2 (P), 158/3 (P), 158/4 (P), 158/5 (P), 158/6 (P), 273, 281, 272/1-A, 272/1, 267, 268 (P), 269 (P), 296 (P), 298/1(P), 299/1, 300/1(P), 306/1, 306/2, 306/3, 306/4, 306/5, 306/6, 306/7, 306/8, 306/9, 307/1, 307/2, 307/3, 307/4, 307/5, 307/6, 307/7, 307/8, 307/9, 307/10, 307/11, 307/12, 307/13, 307/14, 307/15, 307/16, 311/1(P), 311/3(P), 311/4(P), 311/5(P), 311/6(P), 313/1(P), 313/2(P), 313/4(P), 313/5(P), 313/6 (P), 313/7(P), 322/3(P), 322/4(P), 322/6, 322/7, 323/1(P), 323/2(P), 323/3(P), 324/1(P), 337/1, 337/2, 337/4(P), 337/5(P), 338/1, 338/2, 338/3, 338/4, 338/5, 338/6, 338/7, 338/8, 338/9, 338/10, 338/11, 338/12, 338/13, 338/14, 338/15, 338/16, 338/17, 338/18, 339/1, 339/2, 339/3, 339/4, 339/5, 339/6, 339/7, 339/8, 339/9, 339/10, 340/1, 340/2, 340/3, 340/4, 340/5, 340/6, 340/7, 340/8, 340/10, 346/1, 347/1, 348/1, 351/1, 352/1, 352/2, 352/3, 352/4, 352/5, 353/1, 354/1, 354/2, 354/3, 354/4, 354/5, 354/6, 354/7, 354/8, 355/1, 355/2, 355/3, 355/4, 355/5, 355/6, 355/7, 355/8, 355/9, 355/10, 355/11, 356/1, 356/2, 356/3, 356/4, 356/5, 356/6, 356/7, 356/8, 356/9, 357/1, 357/2, 301(P), 302, 239, 262 247 & 237	122 82 Ha	Surveyed & plan submitted to DCF, North Goa

[Signature] [Signature] [Signature] [Signature] [Signature]

Sr. No.	Name of the Taluka	Name of the Village	Finally Identified Sy. Nos. after field survey	Area	Remarks
3	Pernem	Terekhol	14/1(P), 15/1(P)& 15/1 A(P)	5.55 Ha	Surveyed & plan submitted to DCF, North Goa
		Arambol	185/1(P) & 186/1(P)	2.84 Ha	25.97 Ha
		Paliem	154/1(P), 155/1(P), 155/3(P) & 155/4(P)	23.13 Ha	Surveyed one block since the Sy Nos are contiguous & plan submitted to DCF, North Goa
		Pernem	224/1	16.72 Ha	Surveyed & plan submitted to DCF, North Goa
		Casarvorne m	--	NIL	Surveyed/not fitting Pvt Forest criteria
SUB. TOTAL				48.24 ha	
4	Ponda	Betora	193 (P) & 194 (P)	12.25 Ha Balance area yet to be surveyed	12.25 Ha of Sy No. 193(P) & 194(P) Surveyed & plan submitted to DCF, North Goa Balance area yet to be surveyed
		Priol	48/2(P), 49/2(P) & 50/1(P)	2.00 Ha Balance area yet to be surveyed	9.69 Ha of Sy No. 48/2(P), 49/2(P) & 50/1(P) of Priol village & 37/1, 36/1, 36/2 of Cuncolem village has been surveyed as one block since the Sy. No are contiguous & plan submitted to DCF, North Goa Balance area yet to be surveyed
		Cuncolem	37/1, 36/1 & 36/2	7.69 Ha. Balance area yet to be surveyed	
SUB. TOTAL				21.94 ha	
GRAND TOTAL				326.51 ha.	



GOVERNMENT OF GOA
Department of Settlement and Land Records
PANAJI - GOA

PLAN
OF THE LANDS BELONGING TO THE GOVERNMENT OF GOA
IN THE VILLAGE OF GOLEM
AND THE SURROUNDING AREAS
AS PER THE RECORDS OF THE DEPARTMENT OF SETTLEMENT AND LAND RECORDS
GOVERNMENT OF GOA
Scale 1:5000
DATE OF SURVEY 1968

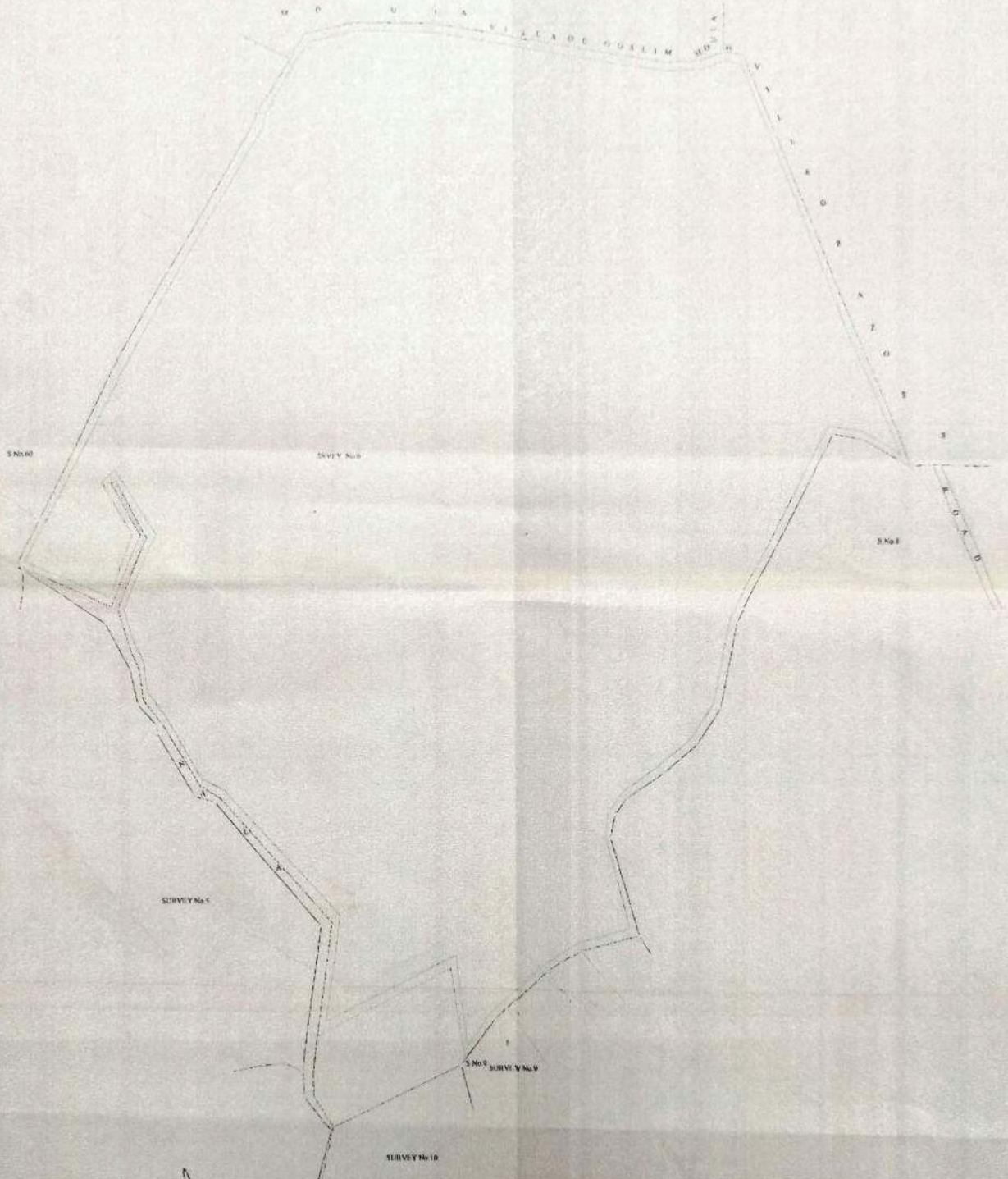

IDENTIFIED BY:

1. 1968 BY THE MAPS AND COMBUSTION OFFICERS, GOVERNMENT OF GOA
2. 1971 BY THE MAPS AND COMBUSTION OFFICERS, GOVERNMENT OF GOA
3. 1974 BY THE MAPS AND COMBUSTION OFFICERS, GOVERNMENT OF GOA
4. 1977 BY THE MAPS AND COMBUSTION OFFICERS, GOVERNMENT OF GOA
5. 1980 BY THE MAPS AND COMBUSTION OFFICERS, GOVERNMENT OF GOA
6. 1983 BY THE MAPS AND COMBUSTION OFFICERS, GOVERNMENT OF GOA
7. 1986 BY THE MAPS AND COMBUSTION OFFICERS, GOVERNMENT OF GOA

SURVEYED BY:

1. 1968 BY THE MAPS AND COMBUSTION OFFICERS, GOVERNMENT OF GOA
2. 1971 BY THE MAPS AND COMBUSTION OFFICERS, GOVERNMENT OF GOA
3. 1974 BY THE MAPS AND COMBUSTION OFFICERS, GOVERNMENT OF GOA
4. 1977 BY THE MAPS AND COMBUSTION OFFICERS, GOVERNMENT OF GOA
5. 1980 BY THE MAPS AND COMBUSTION OFFICERS, GOVERNMENT OF GOA
6. 1983 BY THE MAPS AND COMBUSTION OFFICERS, GOVERNMENT OF GOA
7. 1986 BY THE MAPS AND COMBUSTION OFFICERS, GOVERNMENT OF GOA

APPROVED BY:

1. 1968 BY THE MAPS AND COMBUSTION OFFICERS, GOVERNMENT OF GOA
2. 1971 BY THE MAPS AND COMBUSTION OFFICERS, GOVERNMENT OF GOA
3. 1974 BY THE MAPS AND COMBUSTION OFFICERS, GOVERNMENT OF GOA
4. 1977 BY THE MAPS AND COMBUSTION OFFICERS, GOVERNMENT OF GOA
5. 1980 BY THE MAPS AND COMBUSTION OFFICERS, GOVERNMENT OF GOA
6. 1983 BY THE MAPS AND COMBUSTION OFFICERS, GOVERNMENT OF GOA
7. 1986 BY THE MAPS AND COMBUSTION OFFICERS, GOVERNMENT OF GOA

[Signature]
INSPECTOR GENERAL
LAND RECORDS



GOVERNMENT OF INDIA
Department of Revenue and Land Revenue
PUNJAB

THE LAND REVENUE ACT, 1947
SECTION 10
NOTIFICATION

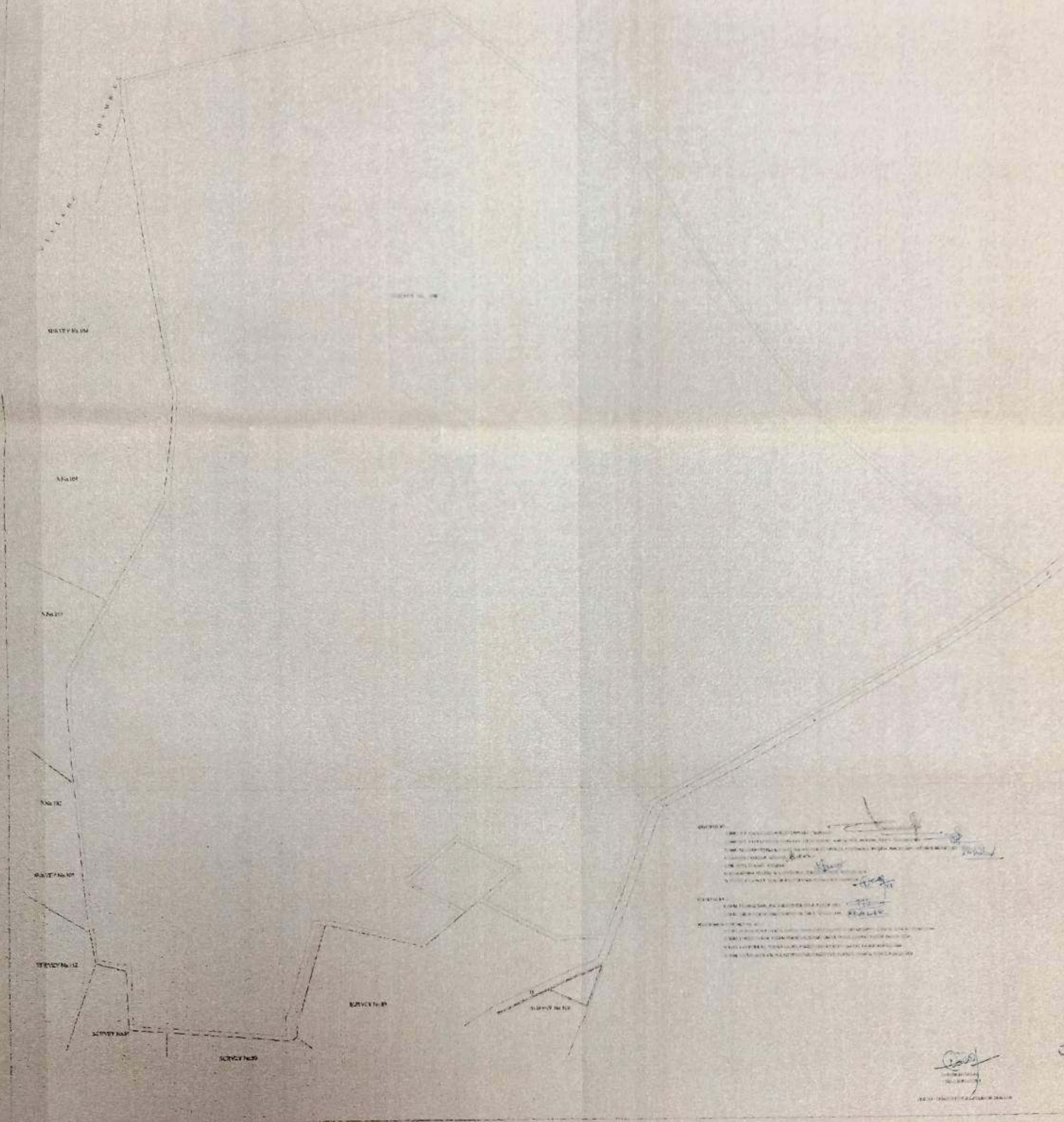

NOTICE
I, the undersigned, being the Officer-in-Charge of the Survey, do hereby certify that the above is a true and correct copy of the Survey Report as submitted to me by the Surveyors concerned.

[Signature]
Officer-in-Charge



 GOVERNMENT OF INDIA

 DEPARTMENT OF LAND REVENUE AND SURVEYS

 PUNJAB

 THE LAND REVENUE ACT, 1901

 SECTION 10

 THE LAND REVENUE (AMENDMENT) ACT, 1907

 SECTION 10

 THE LAND REVENUE (AMENDMENT) ACT, 1911

 SECTION 10

 THE LAND REVENUE (AMENDMENT) ACT, 1913

 SECTION 10

 THE LAND REVENUE (AMENDMENT) ACT, 1915

 SECTION 10

 THE LAND REVENUE (AMENDMENT) ACT, 1917

 SECTION 10

 THE LAND REVENUE (AMENDMENT) ACT, 1919

 SECTION 10

 THE LAND REVENUE (AMENDMENT) ACT, 1921

 SECTION 10

 THE LAND REVENUE (AMENDMENT) ACT, 1923

 SECTION 10

 THE LAND REVENUE (AMENDMENT) ACT, 1925

 SECTION 10

 THE LAND REVENUE (AMENDMENT) ACT, 1927

 SECTION 10

 THE LAND REVENUE (AMENDMENT) ACT, 1929

 SECTION 10

 THE LAND REVENUE (AMENDMENT) ACT, 1931

 SECTION 10

 THE LAND REVENUE (AMENDMENT) ACT, 1933

 SECTION 10

 THE LAND REVENUE (AMENDMENT) ACT, 1935

 SECTION 10

 THE LAND REVENUE (AMENDMENT) ACT, 1937

 SECTION 10

 THE LAND REVENUE (AMENDMENT) ACT, 1939

 SECTION 10

 THE LAND REVENUE (AMENDMENT) ACT, 1941

 SECTION 10

 THE LAND REVENUE (AMENDMENT) ACT, 1943

 SECTION 10

 THE LAND REVENUE (AMENDMENT) ACT, 1945

 SECTION 10

 THE LAND REVENUE (AMENDMENT) ACT, 1947

 SECTION 10

 THE LAND REVENUE (AMENDMENT) ACT, 1949

 SECTION 10

 THE LAND REVENUE (AMENDMENT) ACT, 1951

 SECTION 10

 THE LAND REVENUE (AMENDMENT) ACT, 1953

 SECTION 10

 THE LAND REVENUE (AMENDMENT) ACT, 1955

 SECTION 10

 THE LAND REVENUE (AMENDMENT) ACT, 1957

 SECTION 10

 THE LAND REVENUE (AMENDMENT) ACT, 1959

 SECTION 10

 THE LAND REVENUE (AMENDMENT) ACT, 1961

 SECTION 10

 THE LAND REVENUE (AMENDMENT) ACT, 1963

 SECTION 10

 THE LAND REVENUE (AMENDMENT) ACT, 1965

 SECTION 10

 THE LAND REVENUE (AMENDMENT) ACT, 1967

 SECTION 10

 THE LAND REVENUE (AMENDMENT) ACT, 1969

 SECTION 10

 THE LAND REVENUE (AMENDMENT) ACT, 1971

 SECTION 10

 THE LAND REVENUE (AMENDMENT) ACT, 1973

 SECTION 10

 THE LAND REVENUE (AMENDMENT) ACT, 1975

 SECTION 10

 THE LAND REVENUE (AMENDMENT) ACT, 1977

 SECTION 10

 THE LAND REVENUE (AMENDMENT) ACT, 1979

 SECTION 10

 THE LAND REVENUE (AMENDMENT) ACT, 1981

 SECTION 10

 THE LAND REVENUE (AMENDMENT) ACT, 1983

 SECTION 10

 THE LAND REVENUE (AMENDMENT) ACT, 1985

 SECTION 10

 THE LAND REVENUE (AMENDMENT) ACT, 1987

 SECTION 10

 THE LAND REVENUE (AMENDMENT) ACT, 1989

 SECTION 10

 THE LAND REVENUE (AMENDMENT) ACT, 1991

 SECTION 10

 THE LAND REVENUE (AMENDMENT) ACT, 1993

 SECTION 10

 THE LAND REVENUE (AMENDMENT) ACT, 1995

 SECTION 10

 THE LAND REVENUE (AMENDMENT) ACT, 1997

 SECTION 10

 THE LAND REVENUE (AMENDMENT) ACT, 1999

 SECTION 10

 THE LAND REVENUE (AMENDMENT) ACT, 2001

 SECTION 10

 THE LAND REVENUE (AMENDMENT) ACT, 2003

 SECTION 10

 THE LAND REVENUE (AMENDMENT) ACT, 2005

 SECTION 10

 THE LAND REVENUE (AMENDMENT) ACT, 2007

 SECTION 10

 THE LAND REVENUE (AMENDMENT) ACT, 2009

 SECTION 10

 THE LAND REVENUE (AMENDMENT) ACT, 2011

 SECTION 10

 THE LAND REVENUE (AMENDMENT) ACT, 2013

 SECTION 10

 THE LAND REVENUE (AMENDMENT) ACT, 2015

 SECTION 10

 THE LAND REVENUE (AMENDMENT) ACT, 2017

 SECTION 10

 THE LAND REVENUE (AMENDMENT) ACT, 2019

 SECTION 10

 THE LAND REVENUE (AMENDMENT) ACT, 2021

 SECTION 10

 THE LAND REVENUE (AMENDMENT) ACT, 2023

 SECTION 10

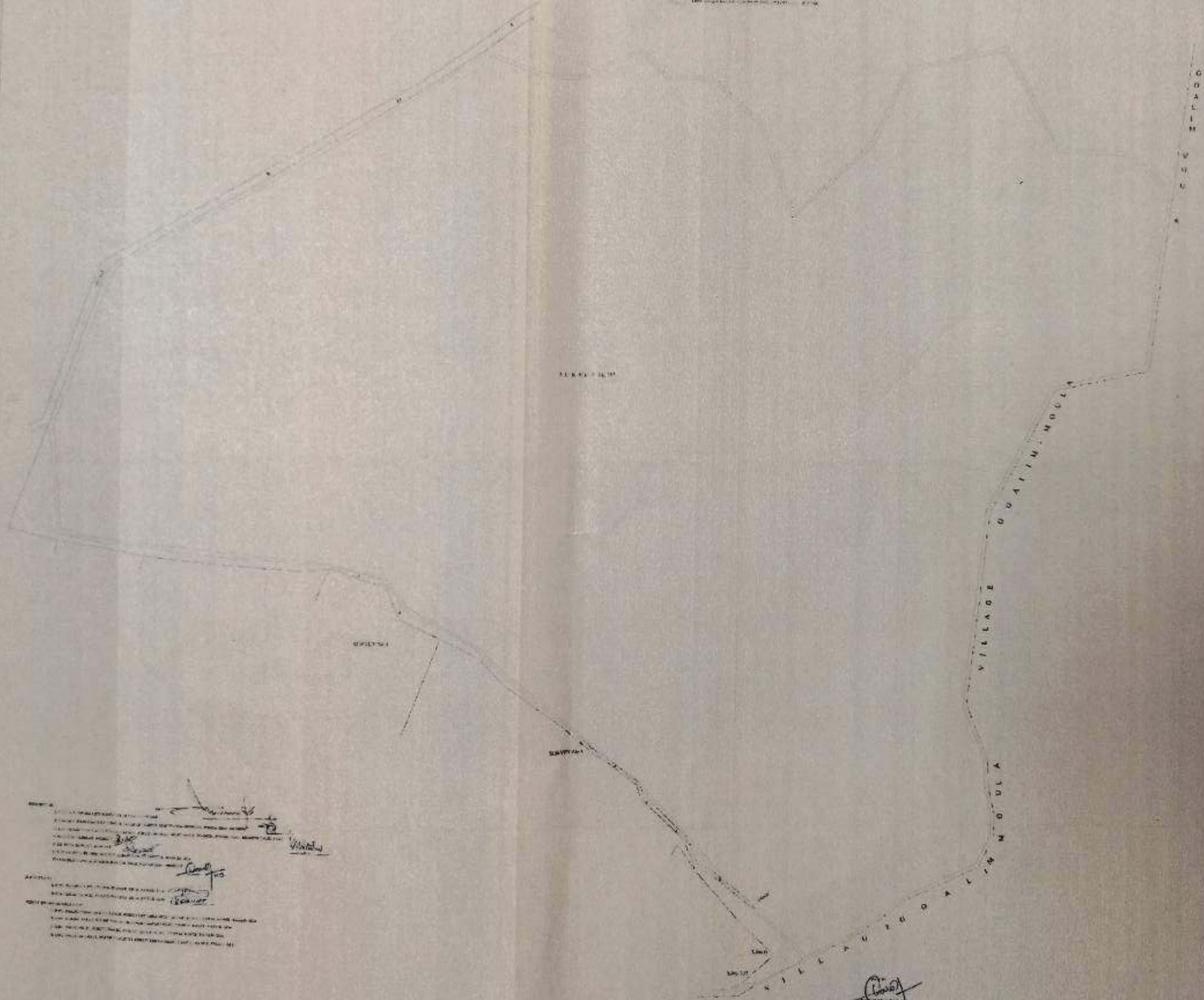

[Handwritten notes and signatures in the bottom left corner, including a signature that appears to be 'W. J. ...']



 [Handwritten signature and text in the bottom right corner]



GOVERNMENT OF GOA
Directorate of Settlement and Land Records
PANAJI - GOA

PLAN

OF THE LAND BELONGING TO PRIVATE FOREST
BY THE NORTH GOA FOREST DIVISION COMPTROLLER
OF VILLAGES GOA IN MOREAU'S TRIGONOMETRIC
VICÉ NOTIFICATION NO. 14 DATED 20TH MARCH
1910 WHICH IS DRAUGHT BY THE DISTRICT SECRETARY
FOREST, SECRETARIAT, PORTUQUEL GOA

Scale 1:1000

AND IS IDENTIFIED AS PRIVATE FOREST OF 580.3116 HECTARES.

IDENTIFIED BY:-

- 1) SHRI V.T. THOMAS, ASSISTANT FORESTER, GOVERNMENT
- 2) SHRI M.Y. KASHI RAMA DY CONSERVATOR OF FOREST, NORTH GOA DIVISION, GOA MEMBER - *M*
- 3) SHRI PRASAD VENO SAI, M.B. PERSONAL FORESTER, NORTH GOA DIVISION, PONDIA GOA. MEMBER SOCIETY - *Prasad*
- 4) S. ANDRA KALLAL, MEMBER - *S. Andra*
- 5) DR. SUDHAKAR ANIL, MEMBER - *S. Andra*
- 6) S. PARULKAR A. PRASAD, C.B. DIVISIONAL FOREST OFFICER, MATIXA GOA
- 7) PARULKAR BIVAN AL, HEAD OFFICE OF D.S. PANAJI GOA. MEMBER - *Parul*

INSPECTED BY:-

- 1) SHRI PRASAD N.S., FIELD SUPERVISOR, D.S. PANAJI GOA
- 2) SHRI S. RAMA SARDAR, FIELD SUPERVISOR, D.S. PANAJI GOA

PRINTED UPON ON GROUND BY:

- 1) SHRI SHAMSUNOOR GAKAL, RANGE FOREST OFFICER, FOREST DEPARTMENT, CAMPAL BANGAL, PANAJI GOA
- 2) SHRI S. RANGAPPAK, RANGE FOREST OFFICER, FOREST DEPARTMENT, CAMPAL BANGAL, PANAJI GOA
- 3) SHRI AMAR DUTTA, FOREST OFFICER, FOREST DEPARTMENT, CAMPAL BANGAL, PANAJI GOA
- 4) SHRI. PAULU SINGRAU, SURVIVAL (WEST) DEPARTMENT, CAMPAL BANGAL, PANAJI GOA

SURVEY No 29

SURVEY No 27

SURVEY No 34

SURVEY No 32

SURVEY No 32

SURVEY No 33

DRAWN BY
[Signature]
PARULKAR BIVAN AL
(100 AND SURVIVAL GOA)



GOVERNMENT OF GOA
Directorate of Settlement and Land Records

PANAJI - GOA

REVISED PLAN
OF THE LAND IDENTIFIED AS PRIVATE FOREST
BY THE THOMAS COMMITTEE (NORTH-GOA, FOREST
DIVISION COMMITTEE PONDA-GOA) IN S NO 66 (PART)
OF VILLAGE SALVADOR-DO-MUNDO OF BARDEZ TALUKA

Scale 1:2000

AREA UNDER PRIVATE FOREST OF S NO 66 (PART) 5.07 HA



169

S.NO	AREA IN MTS SQ
66/1(P)	6140
66/2	5588
66/2-A	5587
66/3	5200
66/4(P)	1474
66/5(P)	1325
66/6	4400
66/7	7200
66/8	2800
66/9	3025
66/12(P)	2027
66/14	4950
	50716

5.07 H.A.

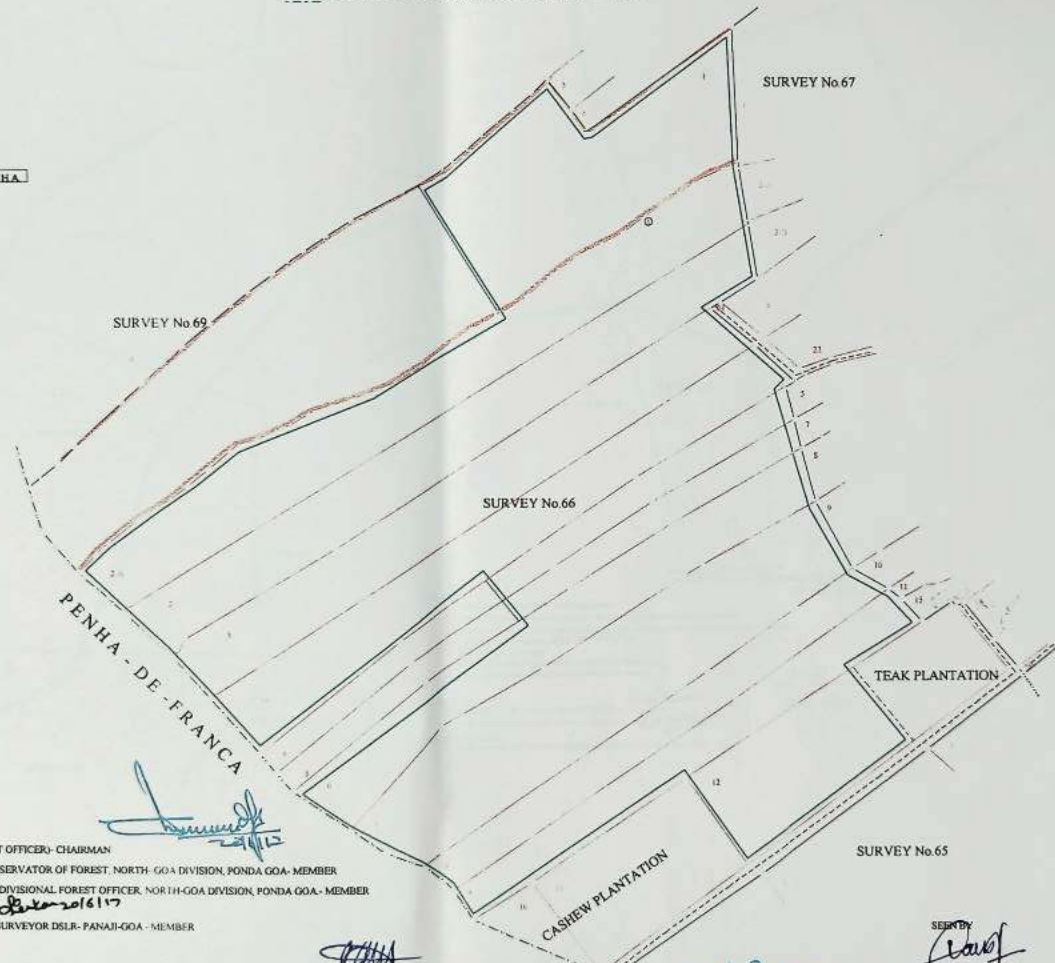

IDENTIFIED BY -

- 1) SHRI V T THOMAS (EX-FOREST OFFICER)- CHAIRMAN
- 2) SHRI M V KAJJIANES DY CONSERVATOR OF FOREST, NORTH-GOA DIVISION, PONDA-GOA- MEMBER
- 3) SHRI PRADEEP VEREKAR, SUB-DIVISIONAL FOREST OFFICER, NOR 1H-GOA DIVISION, PONDA-GOA- MEMBER
- 4) RAJENDRA KERKAR - MEMBER
- 5) DATTAPRASAD PARAB, HEAD SURVEYOR DSLR- PANAJI-GOA - MEMBER
- 6) NITIN SAWANT- MEMBER

SURVEYED AS ON DATE 14/09/2015 BY -

- 1) SHRI PRAMOD NAIK, FIELD SURVEYOR, DSLR, PANAJI- GOA
- 2) SHRI KIRAN GAWDE, FIELD SURVEYOR, DSLR, PANAJI- GOA

SEEN BY
PARESH RIVANKAR
(HEADSURVEYOR)



7/c

19

GOVERNMENT OF GOA
 Directorate of Settlements and Land Records
 PANAJI - GOA
 PLAN

IN THE LAND REVENUE AND FOREST DEPARTMENT
 OF THE GOVERNMENT OF GOA
 IN THE YEAR AND VIGILANCE OF THE FOREST
 DEPARTMENT AND THE LAND RECORDS
 DEPARTMENT GOVERNMENT OF GOA

Scale 1:2000

□ OTHER LANDS NOT FOR SETTLEMENT - 10/100

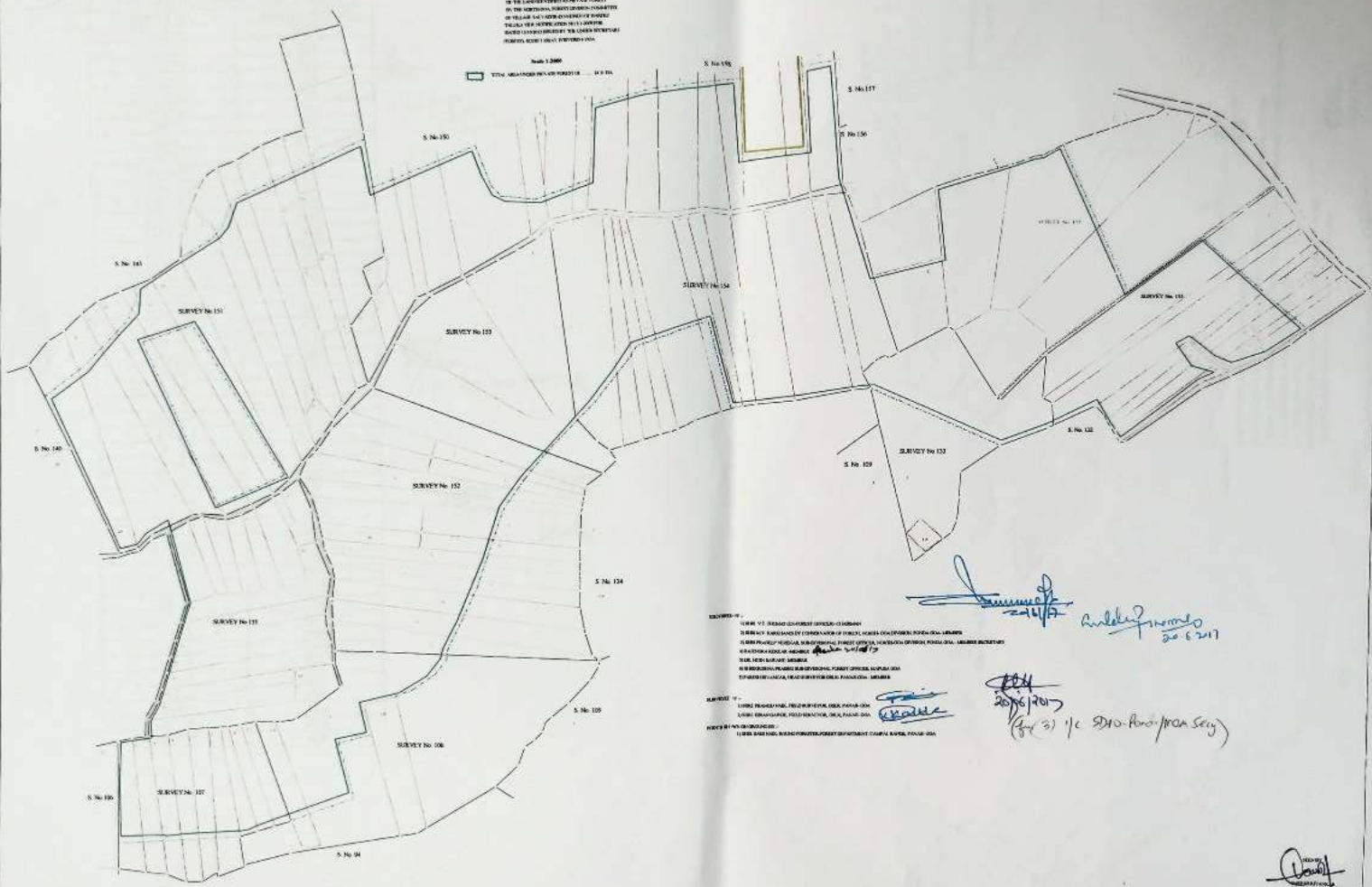

SURVEY 131 -
 FORM VI (REGULATED) UNDER GOVERNMENT
 SURVEY 132 -
 FORM VI (REGULATED) UNDER GOVERNMENT
 SURVEY 133 -
 FORM VI (REGULATED) UNDER GOVERNMENT
 SURVEY 134 -
 FORM VI (REGULATED) UNDER GOVERNMENT
 SURVEY 135 -
 FORM VI (REGULATED) UNDER GOVERNMENT
 SURVEY 136 -
 FORM VI (REGULATED) UNDER GOVERNMENT
 SURVEY 137 -
 FORM VI (REGULATED) UNDER GOVERNMENT
 SURVEY 138 -
 FORM VI (REGULATED) UNDER GOVERNMENT
 SURVEY 139 -
 FORM VI (REGULATED) UNDER GOVERNMENT
 SURVEY 140 -
 FORM VI (REGULATED) UNDER GOVERNMENT
 SURVEY 141 -
 FORM VI (REGULATED) UNDER GOVERNMENT
 SURVEY 142 -
 FORM VI (REGULATED) UNDER GOVERNMENT
 SURVEY 143 -
 FORM VI (REGULATED) UNDER GOVERNMENT
 SURVEY 144 -
 FORM VI (REGULATED) UNDER GOVERNMENT
 SURVEY 145 -
 FORM VI (REGULATED) UNDER GOVERNMENT
 SURVEY 146 -
 FORM VI (REGULATED) UNDER GOVERNMENT
 SURVEY 147 -
 FORM VI (REGULATED) UNDER GOVERNMENT
 SURVEY 148 -
 FORM VI (REGULATED) UNDER GOVERNMENT
 SURVEY 149 -
 FORM VI (REGULATED) UNDER GOVERNMENT
 SURVEY 150 -
 FORM VI (REGULATED) UNDER GOVERNMENT

 20/1/19
 20/6/2019
 (for 7/c SDO-Panaji/PCA Secy)

 20/6/2019

AREA STATEMENT
AREA IDENTIFIED UNDER PRIVATE FOREST

SURVEY NO.	AREA IN SQ. MTS.
107/1 (P)	1347
107/2 (P)	1320
107/3 (P)	1319
107/4 (P)	1372
107/5 (P)	1422
107/6 (P)	1330
107/7	1000
107/8	1075
107/9	1200
108/1 (P)	7387
108/1-A (P)	1304
131/1 (P)	6475
131/2 (P)	1850
131/3 (P)	4875
131/4 (P)	460
131/6 (P)	875
131/7 (P)	550
131/8 (P)	1125
131/10	800
131/11	425
131/12	425
131/13	1000
131/14	750
131/15	825
131/16	575
133/1 (P)	7131
135/1	1225
135/2	750
135/3	875
135/4	925
135/5	925
135/6	1450
135/7	200
135/8	850
135/9	1750
135/10	1675
135/11	1575
135/12	1600
135/13	1175
135/14	2688
135/15	1700
135/16	550
135/17	2025
150/1 (P)	1963
150/2 (P)	1078
150/3 (P)	2590
150/4 (P)	4229

Abh
20.6.17

2) *land clear* *norme*
20.6.2017

Abh
20/06/2017
(i/c SDFO-Perda / Mem. Secy)

PS
F.S

K. Kumar
(F.S.)

(D. S. S.)
H.S.

150/5 (P)	372
150/7 (P)	422
150/8 (P)	279
150/9 (P)	2250
150/10 (P)	2404
150/11	375
150/12	625
150/13	1075
151/3 (P)	319
151/4 (P)	403
151/5 (P)	3942
151/6 (P)	2007
151/7 (P)	3457
151/8 (P)	4769
151/9 (P)	4831
151/10	750
151/11	925
151/12 (P)	2697
151/13 (P)	1254
151/14 (P)	1622
151/15 (P)	3339
151/16 (P)	5582
151/17 (P)	3261
151/18	650
151/19	875
151/20	575
151/21	850
151/22	575
151/23	450
151/24	375
152/1 (P)	3209
152/2	1325
152/3 (P)	909
152/4 (P)	853
152/5	1575
152/6 (P)	2600
152/7 (P)	1883
152/8	1850
152/9 (P)	1520
152/10	1025
152/11 (P)	707
152/12 (P)	1468
152/13 (P)	1352
152/14 (P)	1282
152/15 (P)	1903
152/16 (P)	1852
152/17 (P)	1936
153/1	6500
153/2	5800

Ab Senkan
20/6/2017

2) included from 20.6.2017

[Signature]
20/06/2017

(1/c SDFD - Perolehan / Mem. Secy)

[Signature]
F.S

(1/c Perolehan (F.S))

[Signature]
11.1

153/3 (P)	4698
154/1 (P)	5689
154/2 (P)	1215
154/3 (P)	894
154/4	650
154/5 (P)	3316
154/6 (P)	1408
154/7	1500
154/8	2500
154/9	4650
154/10	6625
154/11	1800
154/12	3275
154/13 (P)	149
155/2	5325
155/3 (P)	6731
155/5 (P)	3920
155/6 (P)	814
155/7	2900
155/8	2950
158/1(P)	3038
158/2(P)	1983
158/3(P)	1620
158/4 (P)	1420
158/5 (P)	607
158/6(P)	2608
TOTAL	243159

Sturken
20/6/17

2) - mtd day
20.6.2017

20/06/2017
(1/c B/FD - (for i) / non Socy)
F.S
(K. G. ...)
(F.S)
(D. ...)
H.S.

24.31 H.A.



6



GOVERNMENT OF GOA
Directorate of Settlement and Land Records
PANAJI - GOA

PLAN
OF THE LAND IDENTIFIED AS PRIVATE FOREST
BY THE NORTH-GOA, FOREST DIVISION COMMITTEE
OF VILLAGE SALVADOR-DO-MONDO OF BARDEZ
TALUKA VIDE NOTIFICATION NO 7-1-2009/FOR
DATED 15/10/2012 ISSUED BY THE UNDER SECRETARY
(FOREST), SECRETARIAT, PORVORIM- GOA

Scale 1:2000

	AREA UNDER PRIVATE FOREST OF S NO 273	4.63 HA.
	AREA UNDER PRIVATE FOREST OF S NO 281	2.06 HA.
	AREA UNDER PRIVATE FOREST OF S NO 272/1-A	0.96 HA.
	AREA UNDER PRIVATE FOREST OF S NO 272/1	4.38 HA.
	TOTAL AREA	12.03 HA.

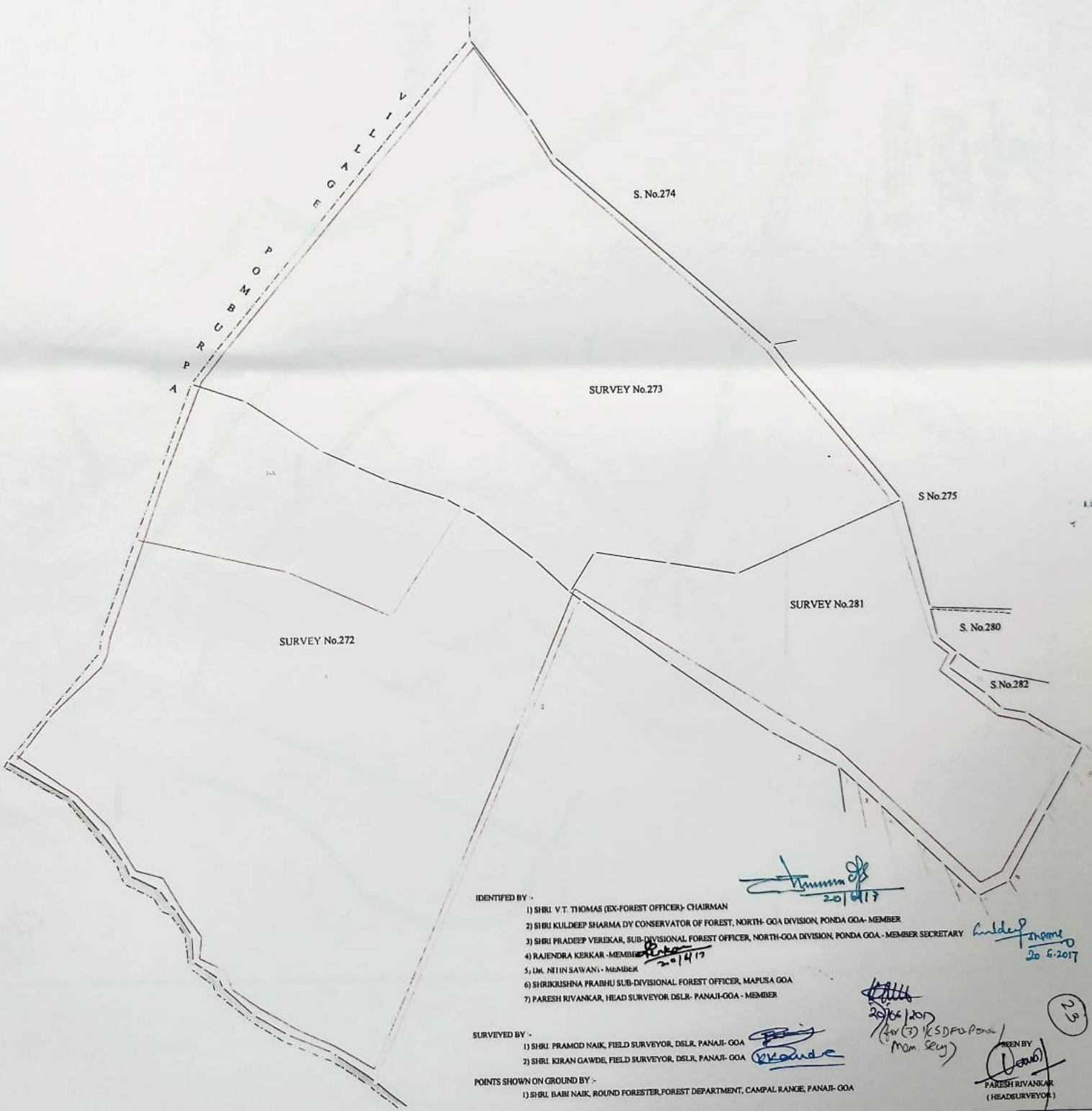

IDENTIFIED BY :-

- 1) SHRI V.T. THOMAS (EX-FOREST OFFICER)- CHAIRMAN
- 2) SHRI KULDEEP SHARMA DY CONSERVATOR OF FOREST, NORTH- GOA DIVISION, PONDA GOA- MEMBER
- 3) SHRI PHADEEP VERLEKAR, SUB-DIVISIONAL FOREST OFFICER, NORTH-GOA DIVISION, PONDA GOA - MEMBER SECRETARY
- 4) RAJENDRA KERKAR - MEMBER
- 5) DR. NEELIN SAWANI - MEMBER
- 6) SHRIKRISHNA PRABHU SUB-DIVISIONAL FOREST OFFICER, MAPUSA GOA
- 7) PARESH RIVANKAR, HEAD SURVEYOR DSLR- PANAJI-GOA - MEMBER

SURVEYED BY :-

- 1) SHRI PRAMOD NAIK, FIELD SURVEYOR, DSLR, PANAJI- GOA
- 2) SHRI KIRAN GAWDE, FIELD SURVEYOR, DSLR, PANAJI- GOA

POINTS SHOWN ON GROUND BY :-

- 1) SHRI BABI NAIK, ROUND FORESTER, FOREST DEPARTMENT, CAMPAL RANGE, PANAJI- GOA

WITNESSED BY

PARESH RIVANKAR
(HEADSURVEYOR)

GOVERNMENT OF INDIA
Department of Agriculture and Land Revenue
PUNJAB - INDIA
PLAN

IN THE LAND REVENUE DEPARTMENT
 BY THE LAND REVENUE OFFICER IN CHARGE
 OF THE LAND REVENUE DEPARTMENT
 PUNJAB - INDIA
 IN THE YEAR 1961
 FOR THE PURPOSE OF THE LAND REVENUE ACT, 1947
 AND THE LAND REVENUE (AMENDMENT) ACT, 1956
 AND THE LAND REVENUE (AMENDMENT) ACT, 1958

ALL THE LANDS SHOWN IN THIS PLAN
 ARE THE PROPERTY OF THE GOVERNMENT OF INDIA
 AND ARE TO BE USED FOR THE PURPOSES OF THE
 LAND REVENUE ACT, 1947 AND THE LAND
 REVENUE (AMENDMENT) ACT, 1956 AND
 THE LAND REVENUE (AMENDMENT) ACT, 1958

TOTAL AREA: 1000 H.A.

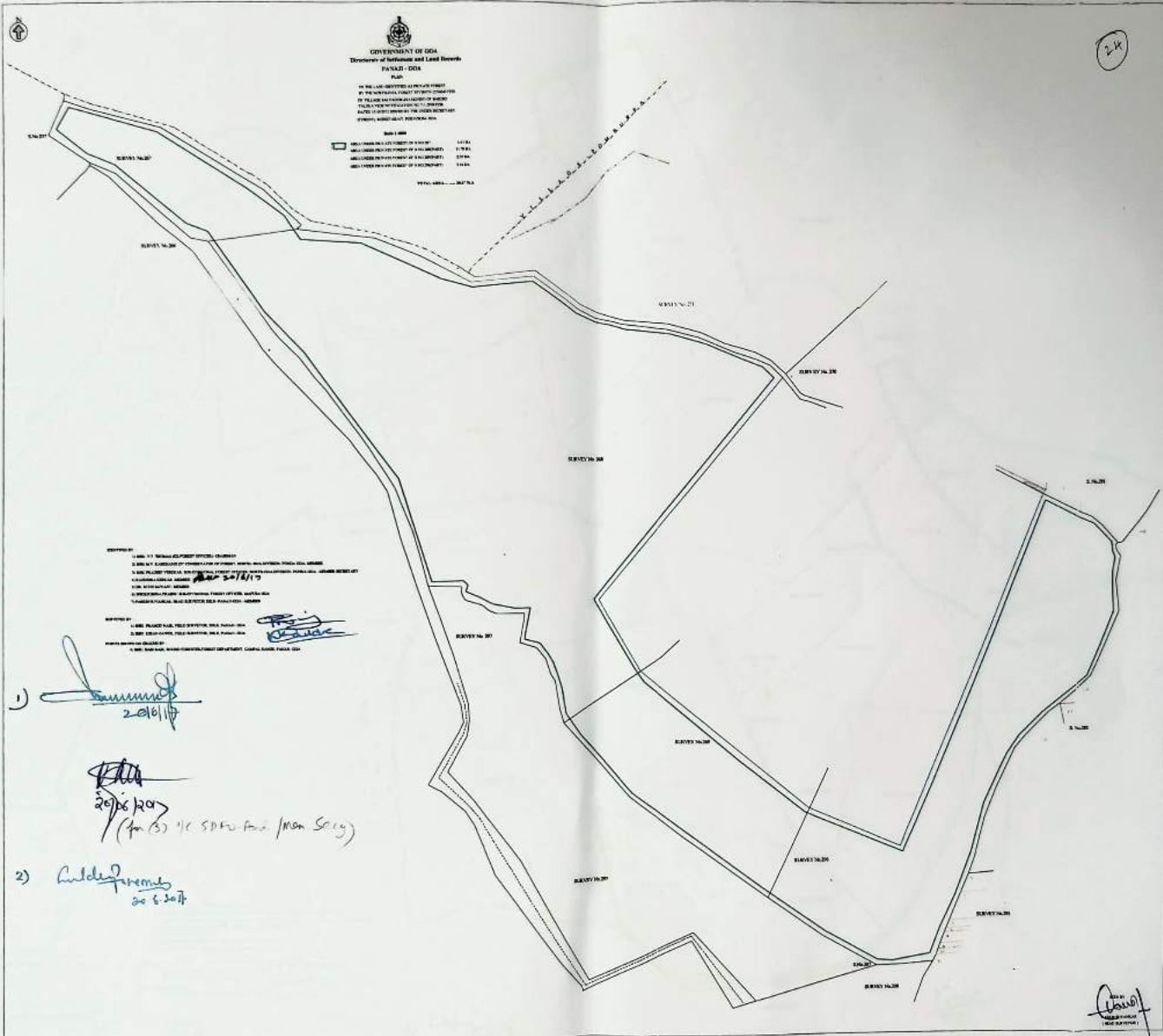

2K

APPROVED BY:
 1. LAND REVENUE OFFICER IN CHARGE
 2. LAND REVENUE OFFICER IN CHARGE
 3. LAND REVENUE OFFICER IN CHARGE
 4. LAND REVENUE OFFICER IN CHARGE
 5. LAND REVENUE OFFICER IN CHARGE
 6. LAND REVENUE OFFICER IN CHARGE
 7. LAND REVENUE OFFICER IN CHARGE
 8. LAND REVENUE OFFICER IN CHARGE
 9. LAND REVENUE OFFICER IN CHARGE
 10. LAND REVENUE OFFICER IN CHARGE

1) 
 20/6/61



 20/6/61
 (for S) 1/2 S.D. No. 100/1 (Man. Secy)

2) 
 20/6/61

 20/6/61

UNIVERSITY OF SOVI
 Faculty of Architecture and Land Reclamation
 Faculty Office
 2016/2017
 1. 2016/2017

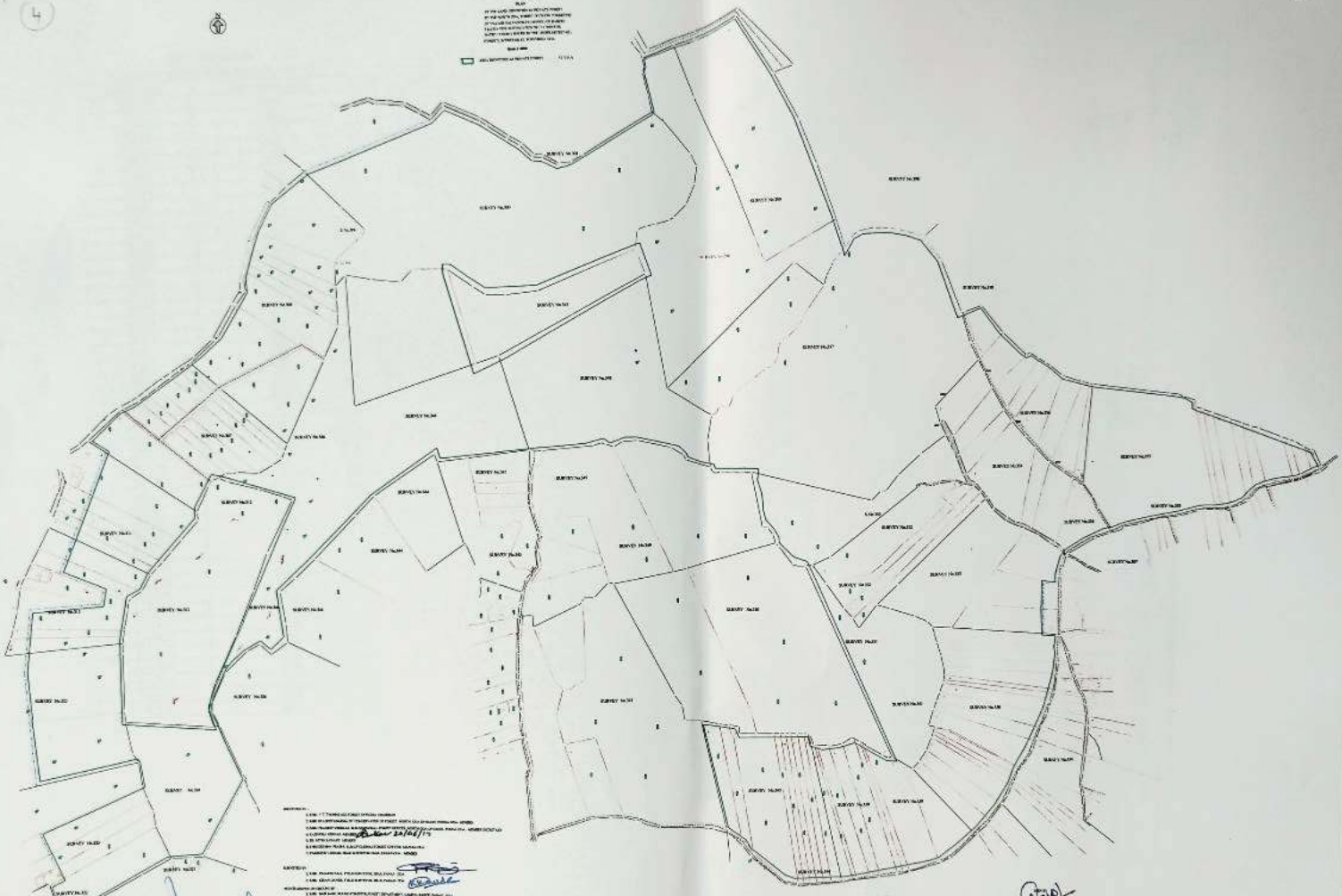
4



NOTES:
 1. ALL LOTS ARE TO BE USED FOR EDUCATIONAL PURPOSES.
 2. THE LOTS ARE TO BE USED FOR EDUCATIONAL PURPOSES.
 3. THE LOTS ARE TO BE USED FOR EDUCATIONAL PURPOSES.
 4. THE LOTS ARE TO BE USED FOR EDUCATIONAL PURPOSES.
 5. THE LOTS ARE TO BE USED FOR EDUCATIONAL PURPOSES.
 6. THE LOTS ARE TO BE USED FOR EDUCATIONAL PURPOSES.
 7. THE LOTS ARE TO BE USED FOR EDUCATIONAL PURPOSES.
 8. THE LOTS ARE TO BE USED FOR EDUCATIONAL PURPOSES.
 9. THE LOTS ARE TO BE USED FOR EDUCATIONAL PURPOSES.
 10. THE LOTS ARE TO BE USED FOR EDUCATIONAL PURPOSES.

① *Summery*
2016/17

20/6/2017

2) *20/6/2017*

[Signature]
FACULTY ARCHITECTURAL DEPARTMENT

AREA STATEMENT

AREA IDENTIFIED UNDER PRIVATE FOREST

SURVEY NO.	AREA IN SQ. MTS.
298/1 (P)	29525
299/1	24600
300/1 (P)	56384
306/1	6500
306/2	2000
306/3	1175
306/4	1250
306/5	1275
306/6	4350
306/7	4925
306/8	625
306/9	5825
307/1	275
307/2	800
307/3	750
307/4	350
307/5	800
307/6	500
307/7	1200
307/8	825
307/9	1850
307/10	550
307/11	1225
307/12	525
307/13	800
307/14	850
307/15	1200
307/16	5700
311/1(P)	5077
311/3(P)	1924
311/4(P)	1466
311/5(P)	1016
311/6(P)	976
313/1(P)	2158
313/2(P)	1976
313/4(P)	356
313/5(P)	2632
313/6(P)	886
313/7(P)	1374
322/3(P)	2508
322/4(P)	1927
322/6	1875
322/7	5425

① 
20/6/17

20/6/17





20/06/2017
(1/0 SDFu Private / New Secy)

~~PS~~ ~~FS~~ ~~Kkald~~ ~~(F.S)~~

11.5.

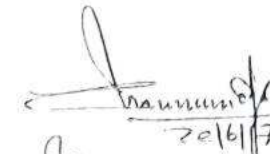
323/1(P)	1827
323/2(P)	6410
323/3(P)	7056
324/1(P)	13703
337/1	9925
337/2	2900
337/4(P)	2554
337/5(P)	2664
338/1	2050
338/2	900
338/3	1175
338/4	1575
338/5	1700
338/6	600
338/7	675
338/8	1725
338/9	1600
338/10	1575
338/11	2625
338/12	200
338/13	775
338/14	625
338/15	625
338/16	1850
338/17	1900
338/18	1700
339/1	1150
339/2	625
339/3	2250
339/4	2100
339/5	2575
339/6	950
339/7	800
339/8	1250
339/9	3750
339/10	2925
340/1	2075
340/2	1575
340/3	7225
340/4	1200
340/5	1075
340/6	1350
340/7	1325
340/8	1575
340/10	1075
346/1	40050
347/1	15350

① 
20/6/17



20/6/17

20/06/2017
(1/c SDF) P. S. P. S. P. S. P. S.

 F.S.  (F.S.)

 H.S.

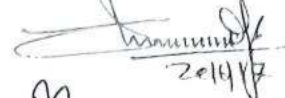
348/1	26575
351/1	14525
352/1	5800
352/2	425
352/3	2400
352/4	1750
352/5	2025
353/1	12375
354/1	2400
354/2	400
354/3	1525
354/4	1325
354/5	4825
354/6	1350
354/7	2300
354/8	2525
355/1	18275
355/2	800
355/3	1075
355/4	1850
355/5	900
355/6	850
355/7	1750
355/8	350
355/9	500
355/10	175
355/11	75
356/1	1025
356/2	1175
356/3	1525
356/4	1125
356/5	1000
356/6	2000
356/7	1975
356/8	1825
356/9	850
357/1	10825
357/2	53475
TOTAL	537299

①  20/06/17

 20/06/17

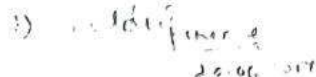
②  20.06.2017

 20/06/2017

(1/c G.F.S. for in / Man. Secy)

 F.S

 (F.S)

 H.S

53.72 H.A.



GOVERNMENT OF GOA
 Directorate of Settlement and Land Records
 PANAJI - GOA

PLAN

OF THE LAND IDENTIFIED AS PRIVATE FOREST
 BY THE NORTH-GOA, FOREST DIVISION COMMITTEE
 OF VILLAGE SALVADOR-DO-MONDO OF BARDEZ
 TALUKA VIDE NOTIFICATION NO 7-1-2009/FOR
 DATED 15/10/2012 ISSUED BY THE UNDER SECRETARY
 (FOREST), SECRETARIAT, PORVORIM- GOA

Scale 1:2000

AREA UNDER PRIVATE FOREST OF S NO 301(PART) 4.11 HA
 AREA UNDER PRIVATE FOREST OF S NO 302 2.91 HA
 TOTAL AREA 7.02 HA



IDENTIFIED BY -

- 1) SHRI V.T THOMAS (EX-FOREST OFFICER)- CHAIRMAN
- 2) SHRI M.V KARKHANS DY CONSERVATOR OF FOREST, NORTH- GOA DIVISION, PONDA GOA- MEMBER
- 3) SHRI PRADEEP VEREKAR, SUB-DIVISIONAL FOREST OFFICER, NORTH-GOA DIVISION, PONDA GOA- MEMBER SECRETARY
- 4) RAJENDRA KERKAR - MEMBER *20/6/17*
- 5) DR. NITIN SAWANT- MEMBER
- 6) SHRIKRISHNA PRABHU SUB-DIVISIONAL FOREST OFFICER, MAPUSA GOA
- 7) PARESH RVANKAR, HEAD SURVEYOR DSLR- PANAJI-GOA - MEMBER

[Signature]
20/6/17

SURVEYED BY -

- 1) SHRI PRAMOD NAIK, FIELD SURVEYOR DSLR, PANAJI- GOA
- 2) SHRI KIRAN GAWDE, FIELD SURVEYOR DSLR, PANAJI- GOA

[Signature]
[Signature]

POINTS SHOWN ON GROUND BY -

- 1) SHRI BABI NAIK, ROUND FORESTER, FOREST DEPARTMENT, CAMPAL RANGIS, PANAJI- GOA

[Signature]
20/6/2017
for (S) Pa-Ponda / Man. Secy

BY
[Signature]
PARESH RVANKAR
(HEAD SURVEYOR)

FILE NO - 19/RESURVEYCELL/DSLR/FOR-DEM/2004

[Signature]
20.6.2017

20



GOVERNMENT OF GOA
 Directorate of Settlement and Land Records
 PANAJI - GOA

PLAN
 OF THE LAND IDENTIFIED AS PRIVATE FOREST
 BY THE NORTH-GOIA FOREST DIVISION COMMITTEE
 OF VILLAGE TRACOL VILAGE OF PONDEN
 TALUKA (NON-AGRICULTURAL) GOA
 DATED 15/02/2012 ISSUED BY THE UNDER SECRETARY
 FORESTS, SCHEMATA, PANAJI, GOA

Scale 1:1000

TRACOL VILAGE

AREA UNDER PRIVATE FOREST OF S.NO.14(PART) ... 3.51 HA.
 AREA UNDER PRIVATE FOREST OF S.NO.15(PART) ... 1.64 HA.
 AREA UNDER PRIVATE FOREST OF S.NO.15(PART) ... 0.21 HA.
 TOTAL AREA ... 5.36 HA.

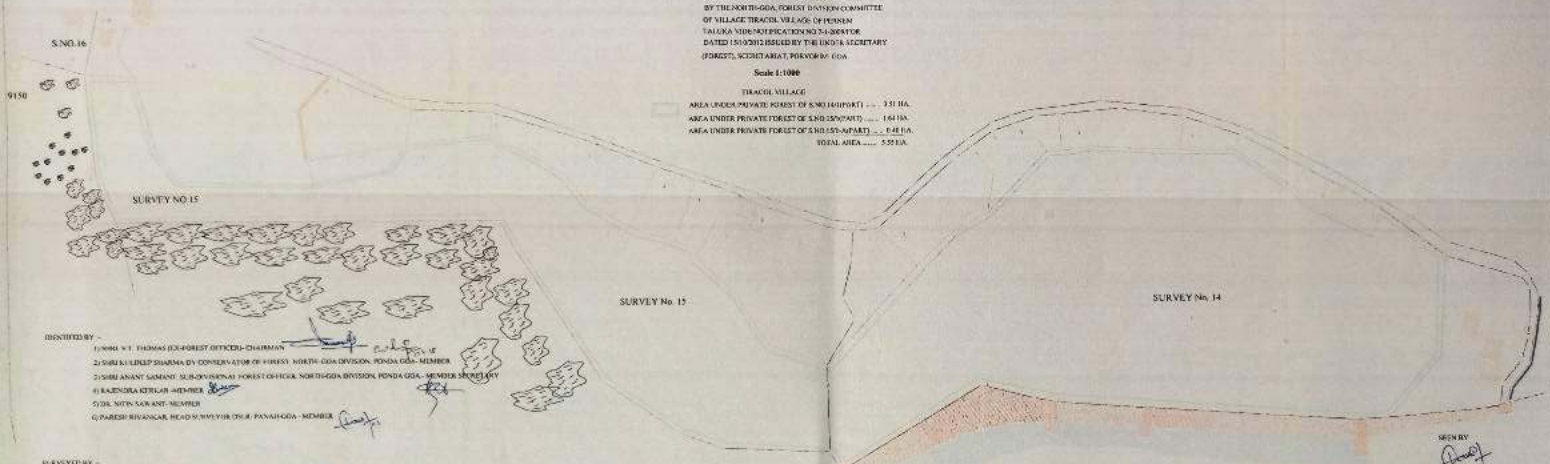

IDENTIFIED BY -

- 1) MRG V.T. THOMAS (EX-FOREST OFFICER)-CHAIRMAN
- 2) SHRI K. LINGJI SHARMA (DY. CONSERVATOR OF FOREST, NORTH-GOIA DIVISION, PONDEN GOA) - MEMBER
- 3) SHRI ANANT SAMANT (SUB-DIVISIONAL FOREST OFFICER, NORTH-GOIA DIVISION, PONDEN GOA) - MEMBER SECRETARY
- 4) SARDAR SUDHAR ANAND - MEMBER
- 5) DR. NITIN SACHANT - MEMBER
- 6) PARSHI BIVANKAR, HEAD SUPERVISOR (W), PANAJI-GOIA - MEMBER

SURVEYED BY -

- 1) SHRI. PRAMOD NAIK, FIELD SURVEYOR, DEPT. PANAJI-GOIA
- 2) SHRI. KAMARAJKAR, FIELD SURVEYOR, DEPT. PANAJI-GOIA

POINTS SHOWN ON GROUND BY

- 1) SHRI. SUNDARRAO GANER, FOREST GUARD, FOREST DEPARTMENT, HANSHI PANAJI-GOIA

SEEN BY

(Signature)
 PARESH BIVANKAR
 (HEAD SURVEYOR)

FILE NO. - 1983/19/2012 L&R/GOA GR/2012

GOVERNMENT OF GOA
 Department of Settlement and Land Records
PANAJI - GOA

PLAN
 OF THE LANDS BELONGING TO THE GOVT. FOREST
 BY THE INTERIOR FOREST DIVISION COMMITTEE
 OF THE DISTRICT PALLEM - ARAMBOL, TALUK OF PERNEM
 IN THE YEAR 1978 & 1979 AND TO BE
 ACQUIRED BY THE LAND ACQUISITION
 ACT, 1952 BY THE GOVERNMENT OF GOA

Scale 1:2000

AGRI-CULTURE

AREA UNDER PLYATE FOREST OF LAND REVENUE	1,17.88 HA.
AREA UNDER PLYATE FOREST OF LAND REVENUE	16.74 HA.
AREA UNDER PLYATE FOREST OF LAND REVENUE	1.26 HA.
AREA UNDER PLYATE FOREST OF LAND REVENUE	1.89 HA.

AGRI-CULTURE

AREA UNDER PLYATE FOREST OF LAND REVENUE	4.75 HA.
AREA UNDER PLYATE FOREST OF LAND REVENUE	1.15 HA.

TOTAL AREA = 207.78 HA.

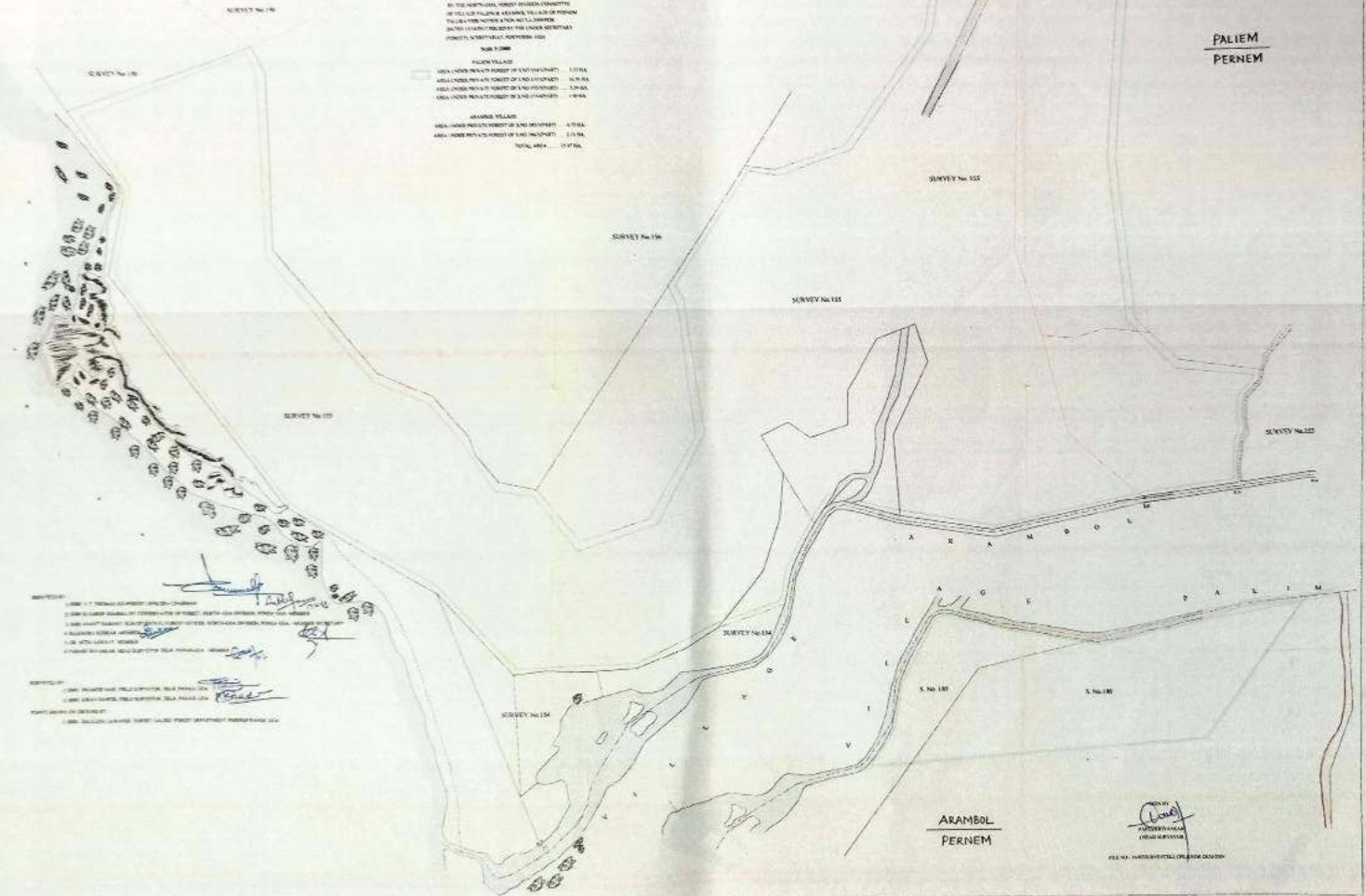

**PALLEM
PERNEM**

**ARAMBOL
PERNEM**

 PROJECTED
 (READ IN REVERSE)

1. To be a 1/4 inch square plot of 100 sq. m.
 2. To be a 1/4 inch square plot of 100 sq. m.
 3. To be a 1/4 inch square plot of 100 sq. m.
 4. To be a 1/4 inch square plot of 100 sq. m.
 5. To be a 1/4 inch square plot of 100 sq. m.
 6. To be a 1/4 inch square plot of 100 sq. m.
 7. To be a 1/4 inch square plot of 100 sq. m.
 8. To be a 1/4 inch square plot of 100 sq. m.
 9. To be a 1/4 inch square plot of 100 sq. m.
 10. To be a 1/4 inch square plot of 100 sq. m.
 11. To be a 1/4 inch square plot of 100 sq. m.
 12. To be a 1/4 inch square plot of 100 sq. m.
 13. To be a 1/4 inch square plot of 100 sq. m.
 14. To be a 1/4 inch square plot of 100 sq. m.
 15. To be a 1/4 inch square plot of 100 sq. m.
 16. To be a 1/4 inch square plot of 100 sq. m.
 17. To be a 1/4 inch square plot of 100 sq. m.
 18. To be a 1/4 inch square plot of 100 sq. m.
 19. To be a 1/4 inch square plot of 100 sq. m.
 20. To be a 1/4 inch square plot of 100 sq. m.
 21. To be a 1/4 inch square plot of 100 sq. m.
 22. To be a 1/4 inch square plot of 100 sq. m.
 23. To be a 1/4 inch square plot of 100 sq. m.
 24. To be a 1/4 inch square plot of 100 sq. m.
 25. To be a 1/4 inch square plot of 100 sq. m.
 26. To be a 1/4 inch square plot of 100 sq. m.
 27. To be a 1/4 inch square plot of 100 sq. m.
 28. To be a 1/4 inch square plot of 100 sq. m.
 29. To be a 1/4 inch square plot of 100 sq. m.
 30. To be a 1/4 inch square plot of 100 sq. m.



GOVERNMENT OF GOA
Directorate of Settlement and Land Records
PANAJI - GOA

PLAN
OF THE LANDS SET ASIDE AS PRIVATE FOREST
BY THE NORTH GOA FOREST DEPARTMENT
OF VILAGE PERHUM VILAGE OF PERHUM
TALUKA VILAGE NORTH GOA DISTRICT
DATED 10/08/1981 ISSUED BY THE DEPUTY SECRETARY
(FOREST) SECRETARIAT, PUNE GOA

Scale 1:2000

PERHUM VILAGE
AREA UNDER PRIVATE FOREST OF 300/251 1673 HA

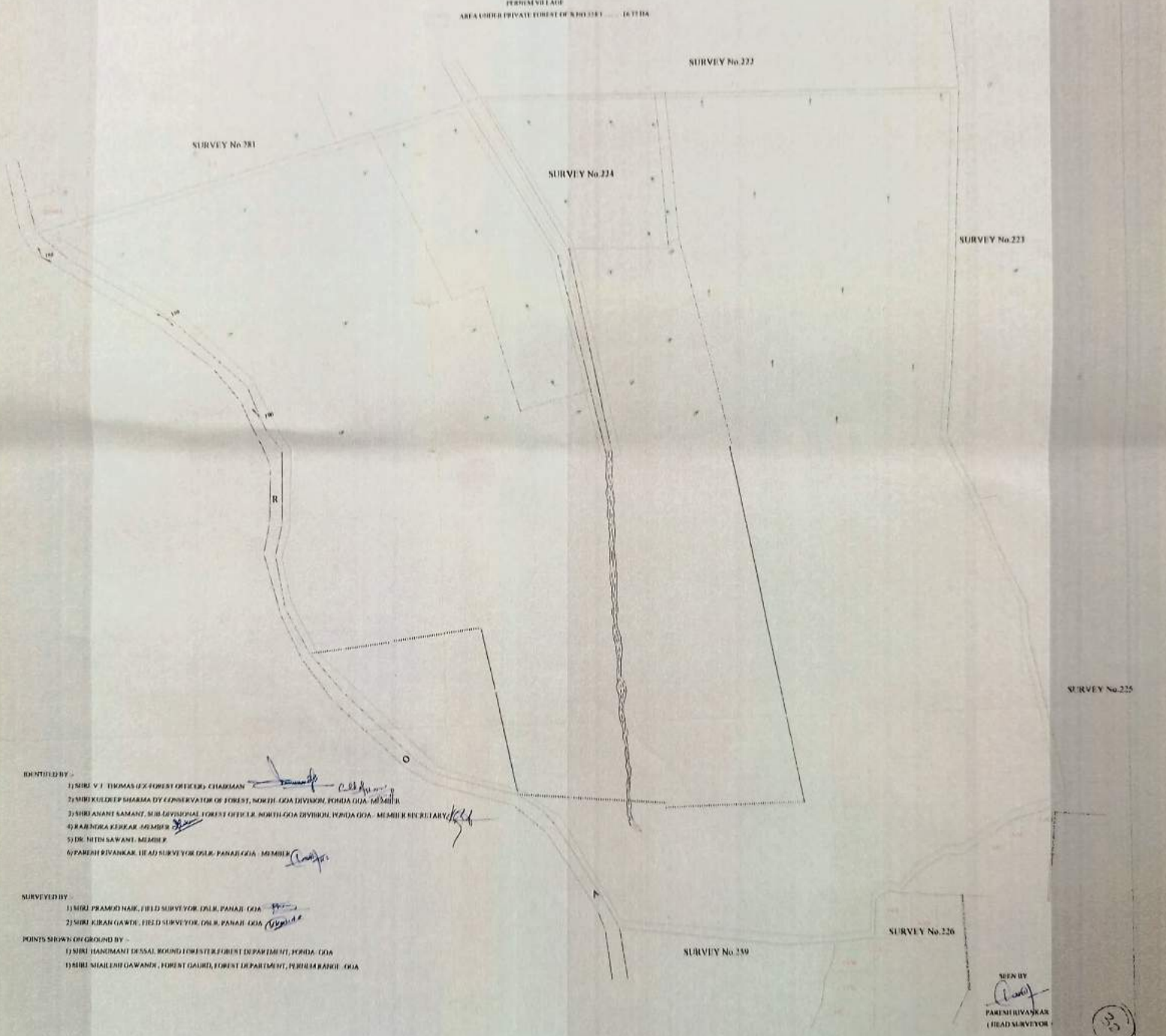

IDENTIFIED BY -

- 1) SHRI V. J. THOMAS (EX-FOREST OFFICER), CHAIRMAN *[Signature]*
- 2) SHRI KULDEEP SHARMA (DY. CONSERVATOR OF FOREST, NORTH GOA DIVISION, PUNE GOA) *[Signature]*
- 3) SHRI ANANT SAMANT (SUB-DIVISIONAL FOREST OFFICER, NORTH GOA DIVISION, PUNE GOA - MEMBER SECRETARY) *[Signature]*
- 4) SHRI MIRA FERREAR (MEMBER) *[Signature]*
- 5) DR. NITHI SAWANT (MEMBER)
- 6) SHRI RAVANKAR (HEAD SURVEYOR (DLR), PANAJI GOA) (MEMBER) *[Signature]*

SURVEYED BY -

- 1) SHRI PRAMOD HARK, FIELD SURVEYOR (DLR), PANAJI, GOA *[Signature]*
- 2) SHRI KIRAN GAWDE, FIELD SURVEYOR (DLR), PANAJI, GOA *[Signature]*

POINTS SHOWN ON GROUND BY -

- 1) SHRI HANUMANT DASSAL (ROUND LOWER STAFF, FOREST DEPARTMENT, PUNE GOA)
- 2) SHRI SHAILASH GAWAND, FOREST GAURDI, FOREST DEPARTMENT, PUNE GOA

SEEN BY
[Signature]
PARENT RAVANKAR
(HEAD SURVEYOR)



GOVERNMENT OF GDA
 Directorate of Settlement and Land Records
 PANAJI - GDA

PLAN
 OF THE LANDS BELONGING TO THE GOVERNMENT
 OF THE GOVERNMENT OF GDA, AND THE LANDS
 BELONGING TO THE PUBLIC, AND THE LANDS
 BELONGING TO THE GOVERNMENT OF GDA, AND THE
 LANDS BELONGING TO THE GOVERNMENT OF GDA.

Scale 1:1000

GOVERNMENT LANDS (SOLID LINE) GOVERNMENT LANDS (DOTTED LINE)
 GOVERNMENT LANDS (DASHED LINE) GOVERNMENT LANDS (DOTTED LINE)
 GOVERNMENT LANDS (DASHED LINE) GOVERNMENT LANDS (DOTTED LINE)



22

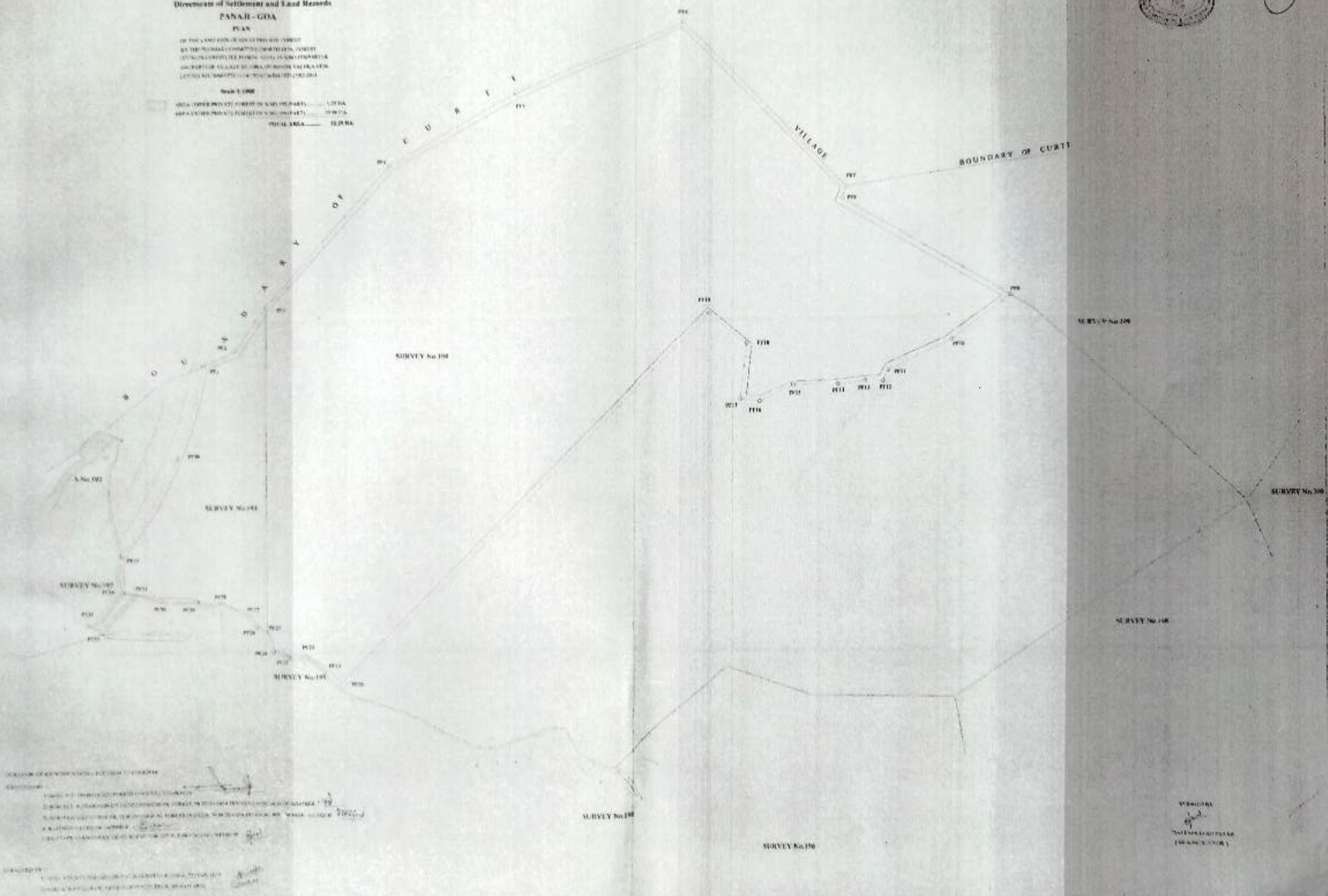

DECLARATION OF GOVERNMENT LANDS (SOLID LINE) GOVERNMENT LANDS (DOTTED LINE)
 GOVERNMENT LANDS (DASHED LINE) GOVERNMENT LANDS (DOTTED LINE)
 GOVERNMENT LANDS (DASHED LINE) GOVERNMENT LANDS (DOTTED LINE)
 GOVERNMENT LANDS (DASHED LINE) GOVERNMENT LANDS (DOTTED LINE)

VERIFIED BY
 THE ASSISTANT COMMISSIONER
 (SETTLEMENTS)



GOVERNMENT OF GOA
 Directorate of Settlement and Land Records
 PANAJI - GOA
 PLAN

OF THE LAND IDENTIFIED AS PRIVATE FOREST
 BY THE NORTH-GOA FOREST DIVISION COMMITTEE
 OF VILLAGE CUNCOLEM AND PRIOL VILLAGE OF PONDA
 TALUKA VIDE NOTIFICATION NO. 3-1-2009 FOR
 DATED 15/02/12 ISSUED BY THE UNDER SECRETARY
 (FOREST), SECRETARIAT, PANVORIM - GOA

Scale 1:2000

CUNCOLEM VILLAGE	
AREA UNDER PRIVATE FOREST OF S.NO 36 (PART)	49 HA
AREA UNDER PRIVATE FOREST OF S.NO 362 (PART)	1.47 HA
AREA UNDER PRIVATE FOREST OF S.NO 371	9.73 HA
PRIOL VILLAGE	
AREA UNDER PRIVATE FOREST OF S.NO 482 (PART)	0.15 HA
AREA UNDER PRIVATE FOREST OF S.NO 492 (PART)	0.43 HA
AREA UNDER PRIVATE FOREST OF S.NO 502 (PART)	1.41 HA

TOTAL AREA — 90.08 HA

IDENTIFIED BY -

- 1) SHRI V.T. THOMAS (EX-FOREST OFFICER) CHAIRMAN
- 2) SHRI KULDEEP SHARMA (V. CONSERVATOR OF FOREST, NORTH-GOA DIVISION, PONDA GOA) MEMBER
- 3) SHRI ANAND K. SURESH (SUB-DIVISIONAL FOREST OFFICER, NORTH-GOA DIVISION, PONDA GOA) MEMBER SECRETARY
- 4) RAJENDRA KERRAR, MEMBER
- 5) DR. NITIN SAWANT, MEMBER
- 6) PARISHRIVANKAR, HEAD SURVEYOR (S.L.R. PANAJI GOA) MEMBER

[Signature]
 12/12/17

[Signature]
 12/12/17

[Signature]
 12/12/17

[Signature]
 12/12/17

SURVEYED BY -

- 1) SHRI PHANODYNAK, FIELD SURVEYOR, (S.L.R. PANAJI GOA)
- 2) SHRI KIRAN GAWDE, FIELD SURVEYOR, (S.L.R. PANAJI GOA)

[Signature]
[Signature]

POINTS SHOWN ON GROUND BY -

- 1) SHRI HANUMANT DESSAI (ROUND FORESTER, FOREST DEPARTMENT, PONDA GOA)
- 2) SHRI SHAMBHUNSHAR DHARGALKAR, FOREST GUARD, FOREST DEPARTMENT, PONDA GOA

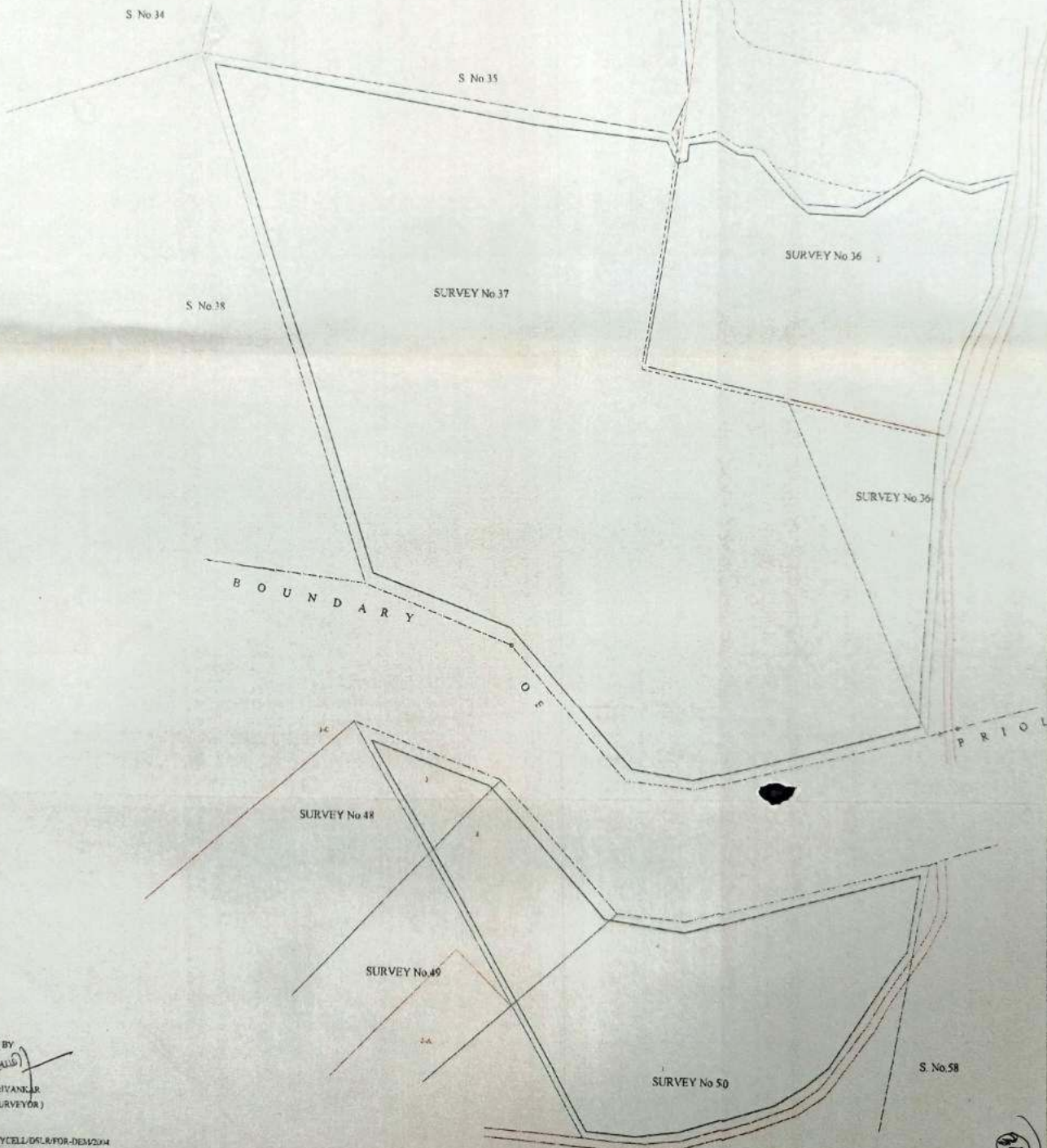

SEEN BY
[Signature]
 PARISHRIVANKAR
 (HEAD SURVEYOR)